

Key: 1151

Town of CHATHAM - Fiscal Year 2024

9/7/2023 9:38 am SEQ #: 1.265

LEGAL

CURRENT OWNER				PARCEL ID				LOCATION			
1038 MAIN STREET REALTY TRUST ELDREDGE GAIL E TRUSTEE 1038 MAIN ST CHATHAM, MA 02633				12F-10A-X36A				1036 MAIN ST			
TRANSFER HISTORY				DOS	T	SALE PRICE		BK-PG (Cert)			
1038 MAIN STREET REALTY T ELDREDGE GAIL ELIZABETH				11/21/2006 06/29/1989	A N	100		21544-271 6790-209			

CLASS	CLASS%	DESCRIPTION			BN ID	BN	CARD	
1020	100	CONDOMINIUM				1	1 of 1	
PMT NO	PMT DT	TY	DESC	AMOUNT	INSP	BY	1st	%

LAND

CD	T	AC/SF/UN	Nbhd	Infl1	Infl2	ADJ BASE	SAF	Infl3	Lpi	VC	CREDIT AMT	ADJ VALUE

TOTAL	SF	ZONING	R20	FRNT	0	ASSESSED	CURRENT	PREVIOUS
Nbhd		NOTE				LAND	0	0
Infl1			BUILDING	150,900	134,900			
Infl2			DETACHED	0	0			
			OTHER	0	0			
			TOTAL	150,900	134,900			

DETACHED

TY	QUAL	COND	DIM/NOTE	YB	UNITS	ADJ PRICE	RCNLD

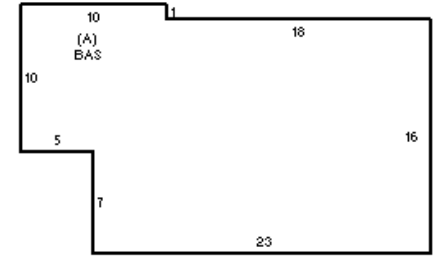

BUILDING

BUILDING	CD	ADJ	DESC	MEASURE		
MODEL	10		CONDO	LIST REVIEW	6/14/2012	MR
STYLE	5	1.00	GARDEN END [100%]			
QUALITY	-	0.90	MINUS AVE [100%]			
FRAME	99	1.00	N/A [100%]			

BLDG COMMENTS
FIRST FLOOR LEVEL UNIT 1036A

G

YEAR BLT	1930	SIZE ADJ	1.000	ELEMENT	CD	DESCRIPTION	ADJ	S	BAT	T	DESCRIPTION	UNITS	YB	ADJ PRICE	RCN	TOTAL RCN	175.455
NET AREA	423	DETAIL ADJ	1.000	COMPLEX	12	KENDRICK CRNR	1.00	A	BAS	L	BAS AREA	423	1930	409.68	173.295		
\$NLA(RCN)	\$415	OVERALL	1.000	UNIT MODEL	99	N/A	1.00										
				VIEW/LOC	1	NONE	1.00										
				HVAC	5	ELECTRIC BB	1.00										
				FUEL SOURCE	3	ELECTRIC	1.00										
				FLOOR LEVEL	2	FIRST FLOOR	1.00										
				NEIGHBORHOOD	1	MID-CHATHAM	1.00										
CAPACITY		UNITS	ADJ														
ROOMS		0	1.00														
BEDROOMS		1	1.00														
FULL BATHS		1	1.00														
1/2 BATHS		0	1.00														
FIXTURES		3	\$2,160														
																CONDITION ELEM	CD
																INTERIOR	
																KITCHEN	
																BATHS	
																EXTERIOR	
																EFF.YR/AGE	1978 / 44
																COND	14 14 %
																FUNC	0
																ECON	0
																DEPR	14 % GD 86
																RCNLD	\$150,900