

Key: 13336

Town of CHATHAM - Fiscal Year 2024

9/7/2023 9:38 am SEQ #: 9.010

LEGALS

CURRENT OWNER				PARCEL ID				LOCATION			
595 MAIN ST LLC PO BOX 25 CHATHAM, MA 02633-0025				15D-15-X43				593 MAIN ST			
TRANSFER HISTORY				DOS	T	SALE PRICE		BK-PG (Cert)			
				05/07/2015	B			28851-145			

CLASS	CLASS%	DESCRIPTION			BN ID	BN	CARD	
1020	100	CONDOMINIUM				1	1 of 1	
PMT NO	PMT DT	TY	DESC	AMOUNT	INSP	BY	1st	%
SS17-16	12/31/2015	20	Splits/Land		12/31/2015		100	100

LAND

CD	T	AC/SF/UN	Nbhd	Inf1	Inf2	ADJ BASE	SAF	Inf3	Lpi	VC	CREDIT AMT	ADJ VALUE

TOTAL	SF	ZONING	FRNT	0	ASSESSED	CURRENT	PREVIOUS
Nbhd		NOTE			LAND	0	0
Inf1			BUILDING	375,100	334,900		
Inf2			DETACHED	0	0		
			OTHER	0	0		
			TOTAL	375,100	334,900		

DETACHED

TY	QUAL	COND	DIM/NOTE	YB	UNITS	ADJ PRICE	RCNLD	PHOTO

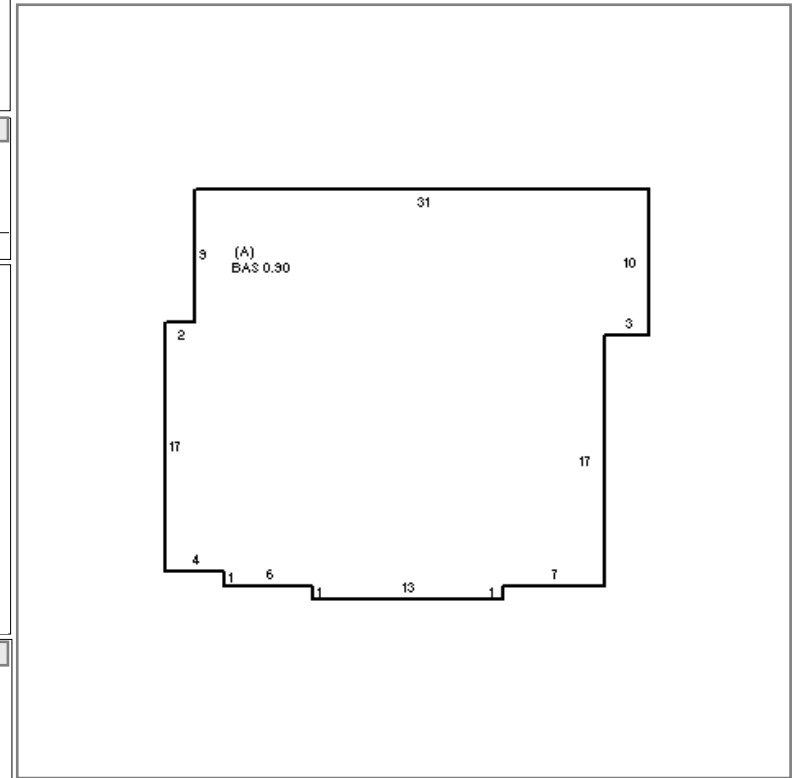

BUILDING

BUILDING	CD	ADJ	DESC	MEASURE	10/6/2016	APK	BLDG COMMENTS
MODEL	10		CONDO	LIST			USF -OVER TWO GARAGE UNITS
STYLE	5	1.00	GARDEN END [100%]	REVIEW	10/6/2016	APK	
QUALITY	+	1.05	PLUS AVE [100%]				
FRAME	99	1.00	N/A [100%]				

BUILDING

YEAR BLT	2014	SIZE ADJ	1.000	ELEMENT	CD	DESCRIPTION	ADJ	S	BAT	T	DESCRIPTION	UNITS	YB	ADJ PRICE	RCN	TOTAL RCN	382,760
NET AREA	748	DETAIL ADJ	1.442	COMPLEX	75	HIGHWHEELER SQ	2.00	A	BAS	L	BAS AREA	748	2014	511.71	382,760		
\$NLA(RCN)	\$512	OVERALL	1.000	UNIT MODEL	5	CMLPX 75 GARDEN	0.70										
				VIEW/LOC	2	AVERAGE	1.00										
				HVAC	9	WARM/COOL AIR	1.03										
				FUEL SOURCE	2	GAS	1.00										
				FLOOR LEVEL	3	SECOND FLOOR	1.00										
				NEIGHBORHOOD	1	MID-CHATHAM	1.00										
CAPACITY		UNITS	ADJ														
ROOMS		0	1.00														
BEDROOMS		0	1.00														
FULL BATHS		0	1.00														
1/2 BATHS		0	1.00														
FIXTURES		0	1.00														
																TOTAL RCN	382,760
																CONDITION ELEM	CD
																INTERIOR	A
																KITCHEN	A
																BATHS	A
																EXTERIOR	A
																EFF.YR/AGE	2014 / 8
																COND	2 2 %
																FUNC	0
																ECON	0
																DEPR	2 % GD 98
																RCNLD	\$375,100