

Key: 1924

Town of CHATHAM - Fiscal Year 2024

9/7/2023 9:38 am SEQ #: 2.090

LEGAL

CURRENT OWNER						PARCEL ID			LOCATION		
NORTHEAST INVESTORS LLC PO BOX 642 VENICE, FL 34284						13H-4F-X6			44 MISTY MEADOW LN		
TRANSFER HISTORY						DOS	T	SALE PRICE	BK-PG (Cert)		
NORTHEAST INVESTORS LLC						01/20/2021	U	190,000	33700-155		
HAMMOND JANE						03/15/2002	QS	142,000	14934-321		
BERNICE J KENYON R L TR						03/05/1996	A	1	10087-221		

CLASS	CLASS%	DESCRIPTION			BN ID	BN	CARD	
1020	100	CONDOMINIUM				1	1 of 1	
PMT NO	PMT DT	TY	DESC	AMOUNT	INSP	BY	1st	%
	03/08/2021	98	SALES QUESTI				100	100

LAND

CD	T	AC/SF/UN	Nbhd	Inf1	Inf2	ADJ BASE	SAF	Inf3	Lpi	VC	CREDIT AMT	ADJ VALUE

TOTAL	SF	ZONING	R20	FRNT	0	ASSESSED	CURRENT	PREVIOUS
						LAND	0	0
						BUILDING	247,600	205,000
						DETACHED	3,300	3,200
						OTHER	0	0
						<b>TOTAL</b>	<b>250,900</b>	<b>208,200</b>

DETACHED

TY	QUAL	COND	DIM/NOTE	YB	UNITS	ADJ PRICE	RCNLD	PHOTO
CPD	A	1.00 20 0.80		1982	200	20.75	3,300	06/14/2012

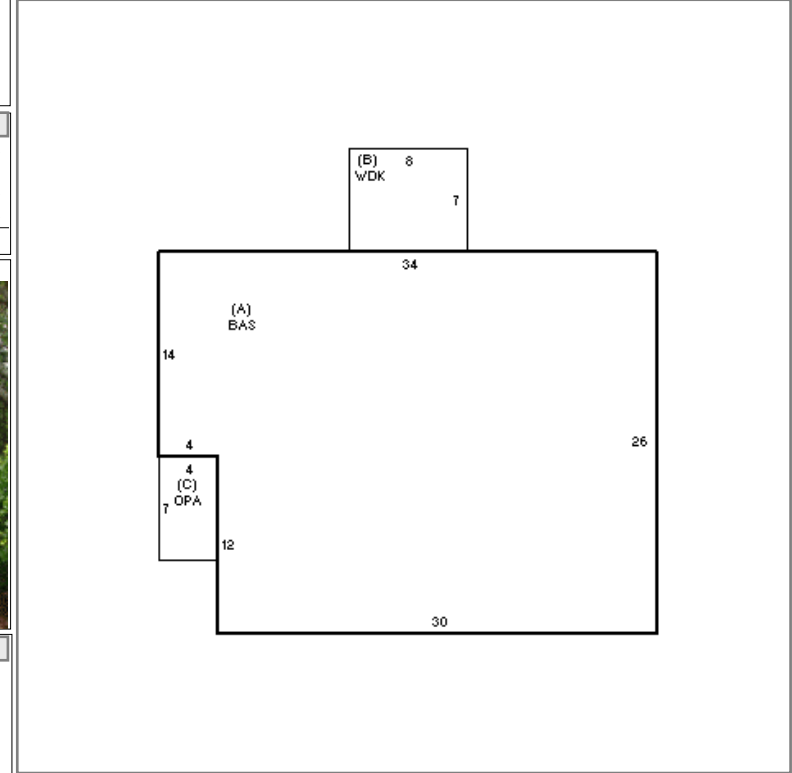

BUILDING

BUILDING	CD	ADJ	DESC	MEASURE	REVIEW
MODEL	10		CONDO		
STYLE	5	1.00	GARDEN END [100%]	LIST	
QUALITY	A	1.00	AVERAGE [100%]	REVIEW	6/14/2012 MR
FRAME	99	1.00	N/A [100%]		

BLDG COMMENTS

G

YEAR BLT	1982	SIZE ADJ	1.000	ELEMENT	CD	DESCRIPTION	ADJ	S	BAT	T	DESCRIPTION	UNITS	YB	ADJ PRICE	RCN	TOTAL RCN	284,642
NET AREA	836	DETAIL ADJ	1.020	COMPLEX	18	PORTSIDE VLG1	1.20	A	BAS	L	BAS AREA	836	1982	326.75	273,166	CONDITION ELEM	CD
\$NLA(RCN)	\$340	OVERALL	1.000	UNIT MODEL	99	N/A	1.00	B	WDK	N	ATT WOOD DECK	56		19.00	1,064	INTERIOR	
				VIEW/LOC	1	NONE	1.00	C	OPA	N	OPEN PORCH	28		24.89	697	KITCHEN	
				HVAC	5	ELECTRIC BB	1.00		BMU	N	BSMT UNFINISHED	245		23.00	5,635	BATHS	
				FUEL SOURCE	3	ELECTRIC	1.00									EXTERIOR	
				FLOOR LEVEL	1	LOWER LEVEL	0.85										
				NEIGHBORHOOD	1	MID-CHATHAM	1.00										
CAPACITY		UNITS	ADJ														
ROOMS		0	1.00														
BEDROOMS		1	1.00														
FULL BATHS		1	1.00														
1/2 BATHS		1	1.00														
FIXTURES		5	\$4,080														
																EFF.YR/AGE	1982 / 40
																COND	13 13 %
																FUNC	0
																ECON	0
																DEPR	13 % GD 87
																RCNLD	\$247,600