

Key: 2213

Town of CHATHAM - Fiscal Year 2024

9/7/2023 9:38 am SEQ #: 2.402

LEGAL

LAND

DETACHED

BUILDING

CURRENT OWNER				PARCEL ID				LOCATION			
TOWN OF CHATHAM TAX COLLECTOR 549 MAIN ST CHATHAM, MA 02633				14C-0-5				224 STAGE HARBOR RD			
TRANSFER HISTORY				DOS	T	SALE PRICE		BK-PG (Cert)			
TOWN OF CHATHAM				01/11/1940	N			()			

CLASS	CLASS%	DESCRIPTION			BN ID	BN	CARD	
9310	100	IMP.SELECT/CITY CNCL				1	1 of 1	
PMT NO	PMT DT	TY	DESC	AMOUNT	INSP	BY	1st	%
01-620	12/19/2001	99	n/a	153,500			100	100
99-367	08/01/1999	99	n/a	153,500			100	100
SP98-85	11/19/1998	99	n/a				100	100

CD	T	AC/SF/UN	Nbhd	Inf1	Inf2	ADJ BASE	SAF	Inf3	Lpi	VC	CREDIT AMT	ADJ VALUE
103	S	5,663	CI	1.00	100	1,125,630	5.02	100	MS7	2.70		733,910

TOTAL	5,663 SF	ZONING	M	FRNT	0	ASSESSED	CURRENT	PREVIOUS
Nbhd	COMMERCIAL	NOTE				LAND	733,900	667,200
Inf1	100		BUILDING	249,100	224,400			
Inf2	100		DETACHED	0	0			
			OTHER	0	0			
						TOTAL	983,000	891,600

TY	QUAL	COND	DIM/NOTE	YB	UNITS	ADJ PRICE	RCNLD



BLDG COMMENTS
DOC KEENE SCOUT HALL
'THE ATWOOD SCHOOL'

BUILDING	CD	ADJ	DESC	MEASURE
MODEL	5		CIM	
STYLE	71	1.43	CLUB/LODGE/HALL [100%]	LIST
QUALITY	A	1.00	AVERAGE [100%]	REVIEW
FRAME	1	1.00	WOOD FRAME [100%]	11/26/2012 DF

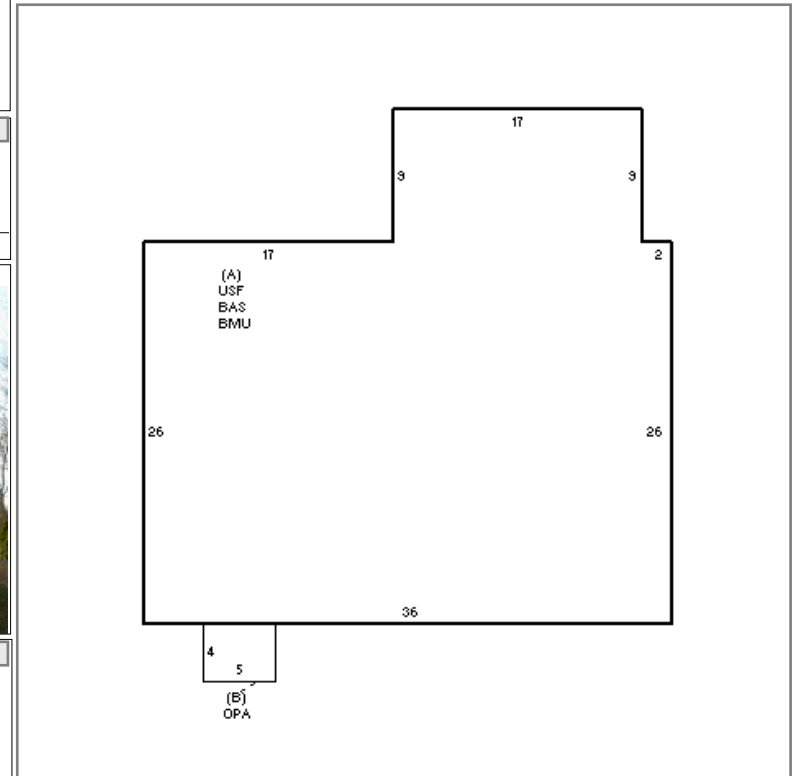

YEAR BLT	1840	SIZE ADJ	1.000
NET AREA	2,178	DETAIL ADJ	1.437
\$NLA(RCN)	\$161	OVERALL	1.000
CAPACITY		UNITS	ADJ
STORIES		1.75	1.00
% HEATED		100	1.00
% AIR COND		100	1.03
% SPRINKLER		100	1.00

ELEMENT	CD	DESCRIPTION	ADJ
FOUNDATION	4	FLR & WALL	1.00
EXT. COVER	1	WOOD SHINGLE	1.00
ROOF SHAPE	1	GABLE	1.00
ROOF COVER	1	ASPH/CMP SHIN	1.00
FLOOR COVER	2	SOFTWOOD	0.95
INT. FINISH	1	PLASTER	1.04
HEATING/COOL	11	HOT WT/COOL AIR	1.02
FUEL SOURCE	2	GAS	1.00

S	BAT	T	DESCRIPTION	UNITS	YB	ADJ PRICE	RCN
A	BMU	N	BSMT UNF	1,089		28.30	30,819
A	BAS	L	BASE AREA	1,089	1840	144.20	157,032
A	USF	L	UP-STRY FIN	1,089	1840	144.20	157,032
B	OPA	N	OPEN PORCH	20		22.40	448
	SPD	N	SPRNK-DRY	3,267		1.70	5,554

TOTAL RCN	350,885
CONDITION ELEM	CD
EXTERIOR	
INTERIOR	
CDN/APP	
EFF.YR/AGE	1985 / 37
COND	29 29 %
FUNC	0
ECON	0
DEPR	29 % GD 71
RCNLD	\$249,100