

Key: 2862

Town of CHATHAM - Fiscal Year 2024

9/7/2023 9:38 am SEQ #: 3.090

LEGALS

CURRENT OWNER				PARCEL ID				LOCATION			
BARBARA M BELLACOSA 2012 TRUST BELLACOSA BARBARA M TRUSTEE 1105 TOWLSTON RD MCLEAN, VA 22102				14J-5-B1				174 KENDRICK RD			
TRANSFER HISTORY				DOS	T	SALE PRICE	BK-PG (Cert)				
BARBARA M BELLACOSA 2012				04/05/2021	QS	1,950,000	33980-326				
PALMER LAWRENCE & PHILIP				01/11/2011	H	1	25173-92				
PALMER L GUY				11/02/1993	QS	230,000	8866-88				

CLASS	CLASS%	DESCRIPTION			BN ID	BN	CARD	
1010	100	SINGLE FAMILY				1	1 of 1	
PMT NO	PMT DT	TY	DESC	AMOUNT	INSP	BY	1st	%
23-594	08/09/2023	1	New Construc	860,000			0	0
23-645	08/07/2023	6	Pools etc	135,000			0	0
	06/29/2021	98	SALES QUESTI				100	100
	02/14/2008	50	Meas & List			RRC	100	100
01-061	01/31/2001	3	Renovations	35,000			100	100

LAND

CD	T	AC/SF/UN	Nbhd	Inf1	Inf2	ADJ BASE	SAF	Inf3	Lpi	VC	CREDIT AMT	ADJ VALUE
100	S	40,000	NC	1.00	100	1,282,750	1.00	100	1.00	OV1	3.50	1,177,920
300	A	0.821	NC	1.00	100	67,200	1.00	100	1.00	OV1	3.50	55,170

TOTAL	1.739 Acres	ZONING	R40	FRNT	0	ASSESSED	CURRENT	PREVIOUS
Nbhd	NORTH CHATHAM	N O T E Fronts on flooded bog Good Distant Waterview, Deeded beach rights on Chatham harbor /end or road				LAND	1,233,100	1,027,500
Inf1	100		BUILDING	863,500	786,200			
Inf2	100		DETACHED	4,100	3,900			
			OTHER	0	0			
						TOTAL	2,100,700	1,817,600

DETACHED

TY	QUAL	COND	DIM/NOTE	YB	UNITS	ADJ PRICE	RCNLD
GZB	A	1.00	10 0.90	1996	144	31.32	4,100

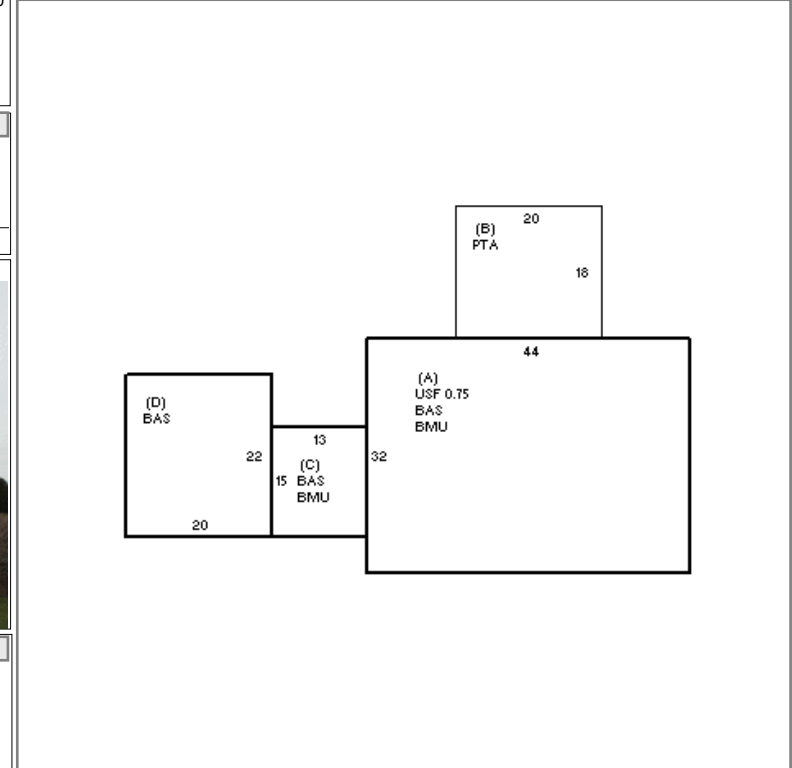

BUILDING

BUILDING	CD	ADJ	DESC	MEASURE	LIST	REVIEW
MODEL	1		RESIDENTIAL			
STYLE	4	1.00	CAPE [100%]			
QUALITY	+	1.20	PLUS AVE [100%]			
FRAME	1	1.00	WOOD FRAME [100%]			

BLDG COMMENTS

G

YEAR BLT	1994	SIZE ADJ	1.000	ELEMENT	CD	DESCRIPTION	ADJ	S	BAT	T	DESCRIPTION	UNITS	YB	ADJ PRICE	RCN	TOTAL RCN	970,234															
NET AREA	3,099	DETAIL ADJ	1.000	FOUNDATION	4	FLR & WALL	1.00	+	BMU	N	BSMT UNFINISHED	1,603		79.34	127,188																	
\$NLA(RCN)	\$313	OVERALL	1.000	EXT. COVER	1	WOOD SHINGLE	1.00	+	BAS	L	BAS AREA	1,603	1994	275.40	441,470																	
				ROOF SHAPE	1	GABLE	1.00	A	USF	L	UP-STRY FIN	1,056	1994	233.69	246,774																	
				ROOF COVER	1	ASPH/CMP SHIN	1.00	B	PTA	N	PATIO/STOOP	360		21.48	7,733																	
				FLOOR COVER	1	HARDWOOD	1.00	D	BAS	L	BAS AREA	440	2001	275.40	121,177																	
				INT. FINISH	2	DRYWALL	1.00		F21	O	FPL 2S 1OP	1		12,451.20	12,451																	
				HEATING/COOL	2	HOT WATER	1.00																									
				FUEL SOURCE	2	GAS	1.00																									
				<table border="1"> <thead> <tr> <th>CONDITION ELEM</th> <th>CD</th> </tr> </thead> <tbody> <tr> <td>EXTERIOR</td> <td>A</td> </tr> <tr> <td>INTERIOR</td> <td>V</td> </tr> <tr> <td>KITCHEN</td> <td>V</td> </tr> <tr> <td>BATHS</td> <td>V</td> </tr> <tr> <td>HEAT</td> <td>A</td> </tr> <tr> <td>ELECT</td> <td>A</td> </tr> </tbody> </table>														CONDITION ELEM	CD	EXTERIOR	A	INTERIOR	V	KITCHEN	V	BATHS	V	HEAT	A	ELECT	A	
CONDITION ELEM	CD																															
EXTERIOR	A																															
INTERIOR	V																															
KITCHEN	V																															
BATHS	V																															
HEAT	A																															
ELECT	A																															
				<table border="1"> <thead> <tr> <th>EFF.YR/AGE</th> <td colspan="2">2011 / 11</td> </tr> </thead> <tbody> <tr> <td>COND</td> <td>11</td> <td>11 %</td> </tr> <tr> <td>FUNC</td> <td>0</td> <td></td> </tr> <tr> <td>ECON</td> <td>0</td> <td></td> </tr> <tr> <td>DEPR</td> <td>11</td> <td>% GD 89</td> </tr> </tbody> </table>														EFF.YR/AGE	2011 / 11		COND	11	11 %	FUNC	0		ECON	0		DEPR	11	% GD 89
EFF.YR/AGE	2011 / 11																															
COND	11	11 %																														
FUNC	0																															
ECON	0																															
DEPR	11	% GD 89																														
				<table border="1"> <thead> <tr> <th>RCNLD</th> <td>\$863,500</td> </tr> </thead> </table>														RCNLD	\$863,500													
RCNLD	\$863,500																															