

Key: 305

Town of CHATHAM - Fiscal Year 2024

9/7/2023 9:38 am SEQ #: 355

LEGALS AND

Table with columns: CURRENT OWNER, PARCEL ID, LOCATION, TRANSFER HISTORY, DOS, T, SALE PRICE, BK-PG (Cert). Includes owner BIRKHOFFER MARTIN J & COLLEEN H and parcel 10F-25-R19.

Table with columns: CLASS, CLASS%, DESCRIPTION, BN ID, BN, CARD. Includes entries for PMT NO, PMT DT, TY, DESC, AMOUNT, INSP, BY, 1st, %.

DETAILED

Table with columns: TOTAL, ZONING, FRNT, ASSESSED, CURRENT, PREVIOUS. Includes details for NBHD MID CHATHAM and assessed values.

Table with columns: TY, QUAL, COND, DIM/NOTE, YB, UNITS, ADJ PRICE, RCNLD. Includes property details like IPG A, QUAL 1.00, COND NV 0.00.

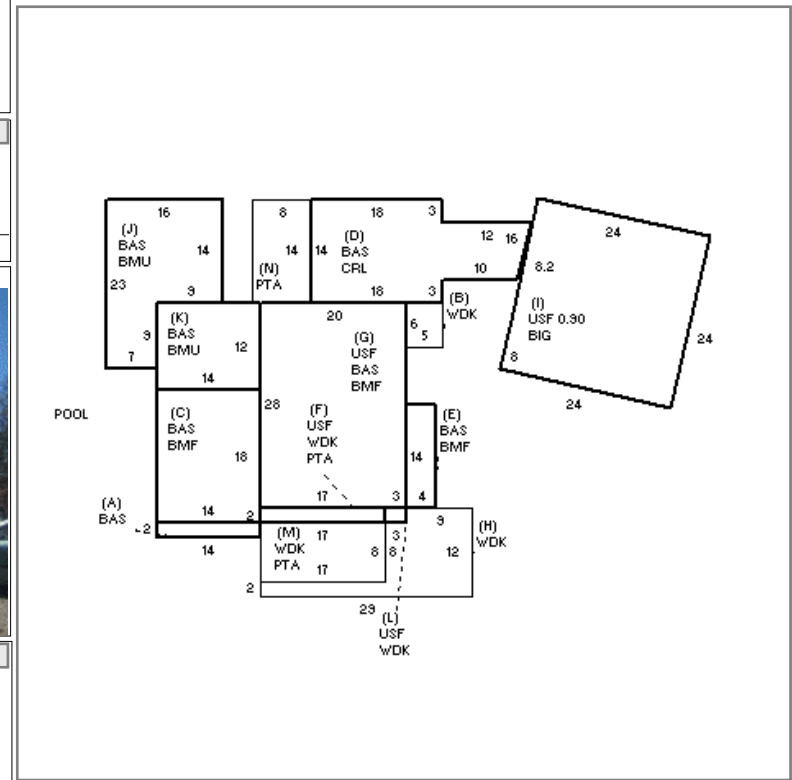

BUILDING

Table with columns: BUILDING, CD, ADJ, DESC, MEASURE, LIST, REVIEW. Includes details like MODEL 1, STYLE 8, QUALITY +.

Table with columns: BLDG COMMENTS. Includes text: PROPANE GAS ,ELECTRIC HEAT, BMF=FAM RM/BDRM/BATH (PER PLANS 7/14/21).

FINANCIAL

Large summary table with columns: YEAR BLT, NET AREA, \$NLA(RCN), CAPACITY, UNITS, ADJ, ELEMENT, CD, DESCRIPTION, ADJ, S, BAT, T, DESCRIPTION, UNITS, YB, ADJ PRICE, RCN, TOTAL RCN, CONDITION ELEM, CD. Includes detailed breakdown of building elements and costs.