

Key: 3249

Town of CHATHAM - Fiscal Year 2024

9/7/2023 9:38 am SEQ #: 3.527

LEGAL LAND

Table with columns: CURRENT OWNER, PARCEL ID, LOCATION, TRANSFER HISTORY, DOS, T, SALE PRICE, BK-PG (Cert). Includes owner name BARBARA H EBERSOLD LIVING TRUST AGMT and parcel details.

Table with columns: CLASS, CLASS%, DESCRIPTION, BN ID, BN, CARD. Includes payment history with PMT NO, PMT DT, TY, DESC, AMOUNT, INSP, BY, 1st, %.

LAND

Table with columns: CD, T, AC/SF/UN, Nbhd, Infl1, Infl2, ADJ BASE, SAF, Infl3, Lpi, VC, CREDIT AMT, ADJ VALUE. Includes totals for assessed, current, and previous values.

Table with columns: ZONING, FRNT, ASSESSED, CURRENT, PREVIOUS. Includes a photo of the property and a table of building characteristics like model, style, quality, frame.

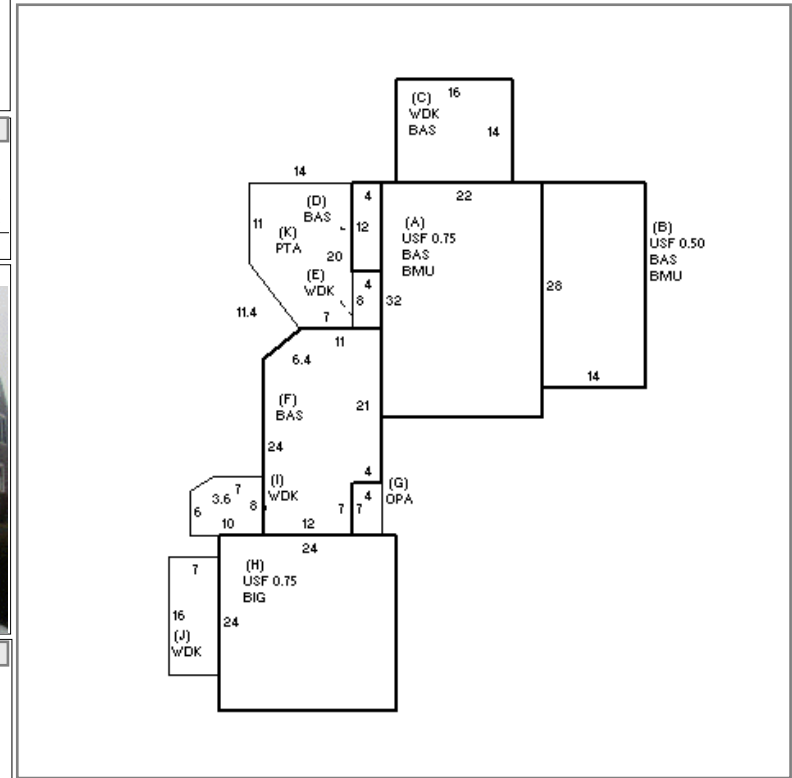

DETACHED

BUILDING

Table with columns: BUILDING, CD, ADJ, DESC, MEASURE, 2/16/2022, NF. Includes a detailed table of building elements (FOUNDATION, EXT. COVER, ROOF SHAPE, etc.) and a table of capacity (STORIES, ROOMS, BEDROOMS, etc.).

BLDG COMMENTS

Summary table with columns: TOTAL RCN, CONDITION ELEM, CD, EFF. YR/AGE, COND, FUNC, ECON, DEPR, RCNLD. Includes values like 998,572, 1995/27, and \$768,900.