

Key: 3321

Town of CHATHAM - Fiscal Year 2024

9/7/2023 9:38 am SEQ #: 3.607

LEGAL

LAND

DETACHED

BUILDING

CURRENT OWNER				PARCEL ID				LOCATION			
MALFA KATHERINE A & DE LIO THOMAS J NOW THOMAS DE LIO REV TRUST & 6136 30TH ST NW WASHINGTON, DC 20015				15G-38-P8				77 PALMER DR			
TRANSFER HISTORY				DOS	T	SALE PRICE	BK-PG (Cert)				
THOMAS DE LIO REV TRUST & MALFA KATHERINE A & DE LI LAMSON CHARLES I				04/19/2023	A	1 ()					
				01/22/2007	A	527,000	21716-135				
				04/19/1974	QS	7,500	2028-277				

CLASS	CLASS%	DESCRIPTION			BN ID	BN	CARD	
1010	100	SINGLE FAMILY				1	1 of 1	
PMT NO	PMT DT	TY	DESC	AMOUNT	INSP	BY	1st	%
17-585	09/06/2017	3	Renovations		07/20/2018	NF	100	100
17-317	05/05/2017	2	Additions	400,000	01/29/2019	TCK	100	100
	05/13/2008	50	Meas & List			RRC	100	100

CD	T	AC/SF/UN	Nbhd	Inf1	Inf2	ADJ BASE	SAF	Inf3	Lpi	VC	CREDIT AMT	ADJ VALUE
100	S	10,000	CH	1.00	100	1.00	100	1.00	R06	2.50		673,810

TOTAL	10,000 SF	ZONING	R40	FRNT	0	ASSESSED	CURRENT	PREVIOUS
Nbhd	CHATHAM	NOTE	LAND	673,800	561,500			
Inf1	100		BUILDING	1,083,300	985,800			
Inf2	100		DETACHED	0	0			
			OTHER	0	0			
TOTAL				1,757,100	1,547,300			

TY	QUAL	COND	DIM/NOTE	YB	UNITS	ADJ PRICE	RCNLD



BLDG COMMENTS	HATCH TO ATTIC
---------------	----------------

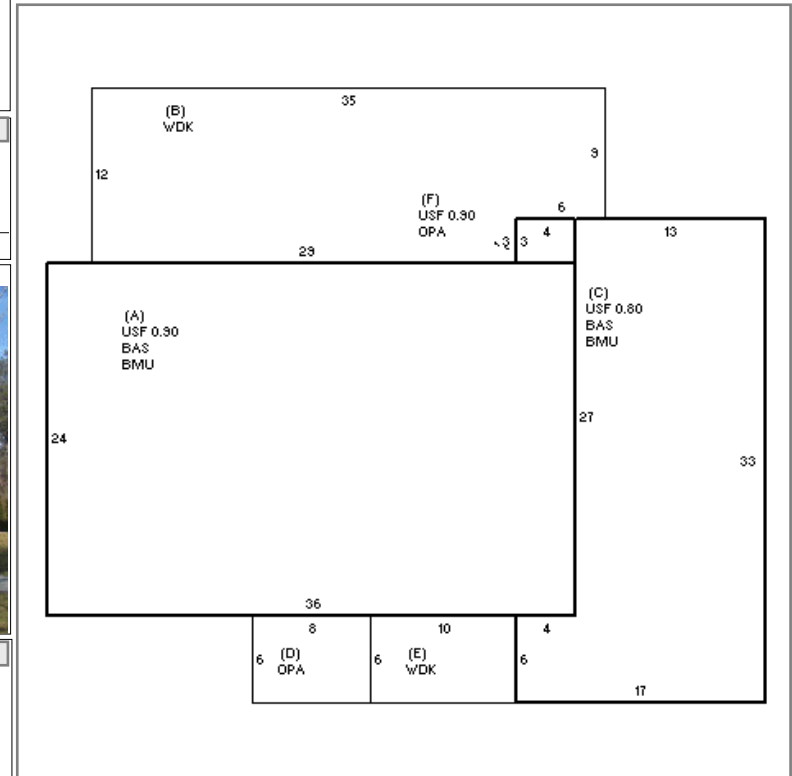

BUILDING	CD	ADJ	DESC	MEASURE	7/20/2018	NF
MODEL	1		RESIDENTIAL	LIST	7/20/2018	NF
STYLE	5	1.00	COLONIAL [100%]	REVIEW	5/1/2019	TD
QUALITY	G	1.55	GOOD [100%]			
FRAME	1	1.00	WOOD FRAME [100%]			

YEAR BLT	1974	SIZE ADJ	1.000
NET AREA	2,468	DETAIL ADJ	1.020
\$NLA(RCN)	\$439	OVERALL	1.000
CAPACITY		UNITS	ADJ
STORIES	1.9	1.00	
ROOMS	7	1.00	
BEDROOMS	3	1.00	
FULL BATHS	2	1.00	
1/2 BATHS	1	1.00	
FIXTURES	8	\$10,118	
UNITS	1	1.00	

ELEMENT	CD	DESCRIPTION	ADJ
FOUNDATION	4	FLR & WALL	1.00
EXT. COVER	1	WOOD SHINGLE	1.00
ROOF SHAPE	3	GAMBREL	1.00
ROOF COVER	2	WOOD SHIN	1.01
FLOOR COVER	1	HARDWOOD	1.00
INT. FINISH	2	DRYWALL	1.00
HEATING/COOL	16	ELECT BB W/AC	1.01
FUEL SOURCE	3	ELECTRIC	1.00

S	BAT	T	DESCRIPTION	UNITS	YB	ADJ PRICE	RCN
+	BMU	N	BSMT UNFINISHED	1,317		105.94	139,520
A	BAS	L	BAS AREA	864	1974	374.01	323,143
A	USF	L	UP-STRY FIN	778	1974	317.36	246,904
+	WDK	N	WOOD DECK	462		90.52	41,821
C	BAS	L	BAS AREA	453	2017	374.01	169,426
+	USF	L	UP-STRY FIN	373	2017	317.36	118,374
+	OPA	N	OPEN PORCH	60		117.96	7,077
	BMG	O	BSMT GARAGE	2		4,292.75	8,586
	F21	O	FPL 2S 1OP	1		16,082.80	16,083
	ODS	O	OUT DOOR SHWR-A	1		2,289.40	2,289

TOTAL RCN	1,083,340
CONDITION ELEM	CD
EXTERIOR	V
INTERIOR	V
KITCHEN	V
BATHS	V
HEAT	U
ELECT	U
EFF.YR/AGE	2022 / 0
COND	0 0 %
FUNC	0
ECON	0
DEPR	0 % GD 100
RCNLD	\$1,083,300