

Key: 3709

Town of CHATHAM - Fiscal Year 2024

9/7/2023 9:38 am SEQ #: 4.040

LEGAL

LAND

DETACHED

BUILDING

Table with columns: CURRENT OWNER, PARCEL ID, LOCATION, TRANSFER HISTORY, DOS, T, SALE PRICE, BK-PG (Cert). Includes owner name LEARY DAVID W TRUSTEE and address 5220 NAHANT ST BETHESDA, MD 20816.

Table with columns: CD, T, AC/SF/UN, Nbhd, Infl1, Infl2, ADJ BASE, SAF, Infl3, Lpi, VC, CREDIT AMT, ADJ VALUE. Includes totals for assessed, current, and previous values.

Table with columns: TY, QUAL, COND, DIM/NOTE, YB, UNITS, ADJ PRICE, RCNLD. Includes property details like 20X40 lot and 800 units.



Table with columns: BLDG COMMENTS. Contains the text 'BMF=EXERCISE RM/OFFICE/BATH'.

Table with columns: CLASS, CLASS%, DESCRIPTION, BN ID, BN, CARD. Includes a list of transactions with PMT NO, PMT DT, TY, DESC, AMOUNT, INSP, BY, 1st, and %.

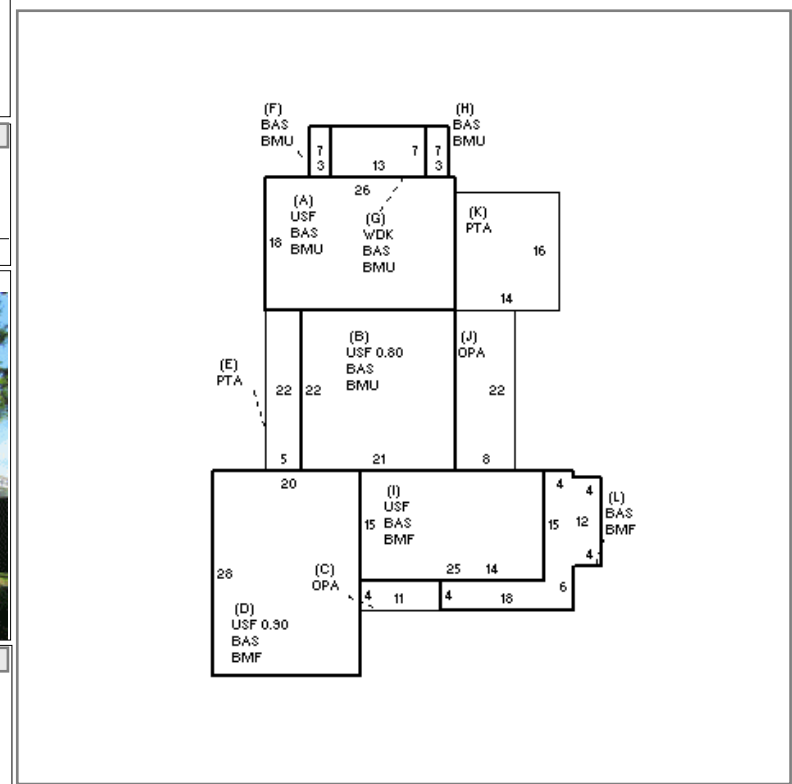

Table with columns: BUILDING, CD, ADJ, DESC, MEASURE, 2/8/2017, MR, LIST, 6/21/2018, MR, REVIEW, 7/3/2018, TD. Includes building details like 'RESIDENTIAL RENO'D ANTIQUE [100%]'.

Table with columns: YEAR BLT, SIZE ADJ, NET AREA, \$NLA(RCN), CAPACITY, UNITS, ADJ. Includes capacity details for stories, rooms, bedrooms, full baths, 1/2 baths, fixtures, and units.

Table with columns: ELEMENT, CD, DESCRIPTION, ADJ, S, BAT, T, DESCRIPTION, UNITS, YB, ADJ PRICE, RCN. Includes a list of building elements like 'FLR & WALL', 'WOOD SHINGLE', 'GABLE', 'WOOD SHIN', 'HARDWOOD', 'DRYWALL', 'WARM/COOL AIR', 'GAS', 'BSMT UNFINISHED', 'BAS AREA', 'UP-STRY FIN', 'OPEN PORCH', 'BSMT FINISH-SEP', 'PATIO/STOOP', 'BAS AREA', 'WOOD DECK', 'UP-STRY FIN', 'GAS LOG/FP/E FP', 'OUT DOOR SHWR-A'.

Table with columns: TOTAL RCN, CONDITION ELEM, CD, EFF. YR/AGE, COND, FUNC, ECON, DEPR, RCNLD. Includes summary statistics like 'TOTAL RCN 3,195,880' and 'RCNLD \$3,132,000'.

Key: 3709

Town of CHATHAM - Fiscal Year 2024

9/7/2023 9:38 am SEQ #: 4.041

LEGAL

CURRENT OWNER				PARCEL ID				LOCATION			
SCHOOL STREET LEARY REV TRUST				16C-16-40				85 SCHOOL ST			
LEARY DAVID W TRUSTEE				TRANSFER HISTORY				DOS	T	SALE PRICE	BK-PG (Cert)
5220 NAHANT ST											
BETHESDA, MD 20816											

CLASS	CLASS%	DESCRIPTION				BN ID	BN	CARD	
1010	100	SINGLE FAMILY					2	2 of 2	
PMT NO	PMT DT	TY	DESC	AMOUNT	INSP	BY	1st	%	

LAND

CD	T	AC/SF/UN	Nbhd	Inf1	Inf2	ADJ BASE	SAF	Inf3	Lpi	VC	CREDIT AMT	ADJ VALUE

TOTAL	ZONING	FRNT	ASSESSED	CURRENT	PREVIOUS
Nbhd	NOTE		LAND	384,800	
Inf1		BUILDING			
Inf2		DETACHED			
			TOTAL		

DETACHED

TY	QUAL	COND	DIM/NOTE	YB	UNITS	ADJ PRICE	RCNLD	PHOTO
								06/21/2018

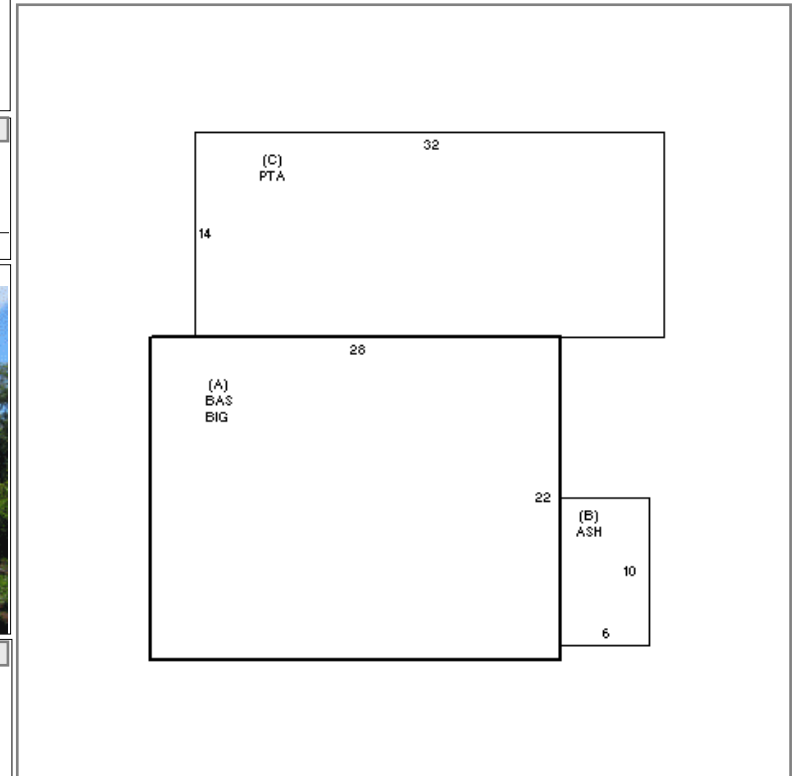

BUILDING

BUILDING	CD	ADJ	DESC	MEASURE	2/8/2017	MR
MODEL	1		RESIDENTIAL	LIST	6/21/2018	MR
STYLE	17	0.95	GAR/APT [100%]	REVIEW	7/3/2018	TD
QUALITY	G	1.55	GOOD [100%]	BLDG COMMENTS		
FRAME	1	1.00	WOOD FRAME [100%]	NO KITCHEN		

YEAR BLT	2016	SIZE ADJ	1.000	ELEMENT	CD	DESCRIPTION	ADJ	S	BAT	T	DESCRIPTION	UNITS	YB	ADJ PRICE	RCN	TOTAL RCN	409.321															
NET AREA	616	DETAIL ADJ	0.959	FOUNDATION	4	FLR & WALL	1.00	A	BIG	N	BUILT-IN GARAGE	616		118.80	73,183																	
\$NLA(RCN)	\$664	OVERALL	1.000	EXT. COVER	1	WOOD SHINGLE	1.00	A	BAS	L	BAS AREA	616	2016	506.84	312,215																	
				ROOF SHAPE	1	GABLE	1.00	B	ASH	N	ATT SHED	60		93.93	5,636																	
				ROOF COVER	2	WOOD SHIN	1.01	C	PTA	N	PATIO/STOOP	448		27.74	12,430																	
				FLOOR COVER	1	HARDWOOD	1.00		ODS	O	OUT DOOR SHWR-A	1		2,289.40	2,289																	
				INT. FINISH	2	DRYWALL	1.00																									
				HEATING/COOL	1	FORCED AIR	1.00																									
				FUEL SOURCE	2	GAS	1.00																									
				<table border="1"> <tr> <th>CONDITION ELEM</th> <th>CD</th> </tr> <tr> <td>EXTERIOR</td> <td>A</td> </tr> <tr> <td>INTERIOR</td> <td>A</td> </tr> <tr> <td>KITCHEN</td> <td>A</td> </tr> <tr> <td>BATHS</td> <td>A</td> </tr> <tr> <td>HEAT</td> <td>A</td> </tr> <tr> <td>ELECT</td> <td>A</td> </tr> </table>														CONDITION ELEM	CD	EXTERIOR	A	INTERIOR	A	KITCHEN	A	BATHS	A	HEAT	A	ELECT	A	
CONDITION ELEM	CD																															
EXTERIOR	A																															
INTERIOR	A																															
KITCHEN	A																															
BATHS	A																															
HEAT	A																															
ELECT	A																															
				<table border="1"> <tr> <th>EFF.YR/AGE</th> <td colspan="2">2016 / 6</td> </tr> <tr> <td>COND</td> <td>6</td> <td>6 %</td> </tr> <tr> <td>FUNC</td> <td>0</td> <td></td> </tr> <tr> <td>ECON</td> <td>0</td> <td></td> </tr> <tr> <td>DEPR</td> <td>6</td> <td>% GD 94</td> </tr> </table>														EFF.YR/AGE	2016 / 6		COND	6	6 %	FUNC	0		ECON	0		DEPR	6	% GD 94
EFF.YR/AGE	2016 / 6																															
COND	6	6 %																														
FUNC	0																															
ECON	0																															
DEPR	6	% GD 94																														
				<table border="1"> <tr> <th>RCNLD</th> <td>\$384,800</td> </tr> </table>														RCNLD	\$384,800													
RCNLD	\$384,800																															