

Key: 3961

Town of CHATHAM - Fiscal Year 2024

9/7/2023 9:38 am SEQ #: 4.334

LEGALS

LAND

DETACHED

BUILDING

Table with columns: CURRENT OWNER, PARCEL ID, LOCATION, TRANSFER HISTORY, DOS, T, SALE PRICE, BK-PG (Cert). Includes owner details for Steven & Stacy A Bryerton.

Table with columns: CD, T, AC/SF/UN, Nbhhd, Inf1, Inf2, ADJ BASE, SAF, Inf3, Lpi, VC, CREDIT AMT, ADJ VALUE. Includes zoning and assessed values.

Table with columns: TY, QUAL, COND, DIM/NOTE, YB, UNITS, ADJ PRICE, RCNLD. Includes building details like IPC, SHF, WDK.



BLDG COMMENTS table with columns: BUILDING, CD, ADJ, DESC, MEASURE, 2/11/2022, NF.

Table with columns: CLASS, CLASS%, DESCRIPTION, BN ID, BN, CARD. Includes payment history for 1010 class.

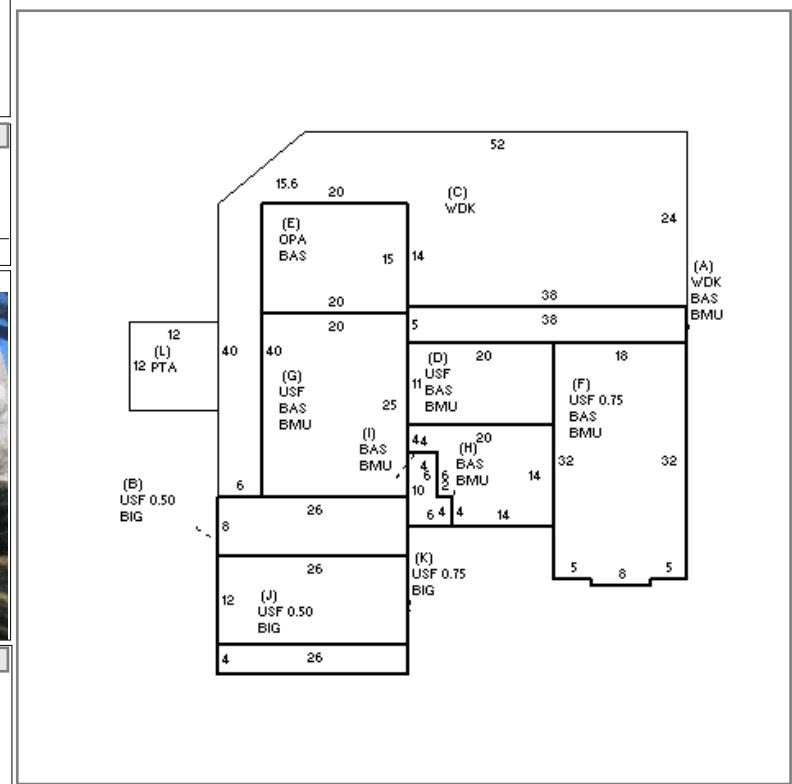

Table with columns: YEAR BLT, SIZE ADJ, NET AREA, \$NLA(RCN), CAPACITY, UNITS, ADJ. Includes capacity breakdown for stories, rooms, etc.

Table with columns: ELEMENT, CD, DESCRIPTION, ADJ, S, BAT, T, DESCRIPTION, UNITS, YB, ADJ PRICE, RCN. Includes foundation, roof, floor, and other building elements.

Table with columns: TOTAL RCN, CONDITION ELEM, CD, EFF. YR/AGE, COND, FUNC, ECON, DEPR, RCNLD. Includes total RCN of 1,799,222 and condition details.