

Key: 4142

Town of CHATHAM - Fiscal Year 2024

9/7/2023 9:38 am SEQ #: 4.545

LEGAL

LAND

DETACHED

BUILDING

INDING

CURRENT OWNER				PARCEL ID				LOCATION			
STEVEN G CALABRESI IRREV TRUST CALABRESI MARY TYLER TRUSTEE 104 PROSPECT ST PROVIDENCE, RI 02906				17C-58A-X1				162 MAIN ST			
TRANSFER HISTORY				DOS	T	SALE PRICE		BK-PG (Cert)			
STEVEN G CALABRESI IRREV				01/27/2014	A	1 27955-104					
CALABRESI STEVEN G				06/03/2013	A	1 27425-177					
CALABRESI MARY TYLER & ST				02/28/2013	A	1 27170-70					

CLASS	CLASS%	DESCRIPTION			BN ID	BN	CARD	
1020	100	CONDOMINIUM				1	1 of 1	
PMT NO	PMT DT	TY	DESC	AMOUNT	INSP	BY	1st	%
15-602	10/13/2015	10	Reroof	7,000	04/04/2022	TCK	100	100

CD	T	AC/SF/UN	Nbhd	Inf1	Inf2	ADJ BASE	SAF	Inf3	Lpi	VC	CREDIT AMT	ADJ VALUE

TOTAL	SF	ZONING	R20	FRNT	0	ASSESSED	CURRENT	PREVIOUS
Nbhd		NOTE				LAND	0	0
Inf1			BUILDING	1,664,400	1,481,800			
Inf2			DETACHED	0	0			
			OTHER	0	0			
						TOTAL	1,664,400	1,481,800

TY	QUAL	COND	DIM/NOTE	YB	UNITS	ADJ PRICE	RCNLD



BLDG COMMENTS

CHANNEL VIEW

BUILDING	CD	ADJ	DESC	MEASURE		
MODEL	10		CONDO	LIST		
STYLE	2	1.00	FREE STANDING [100%]	REVIEW	4/19/2022	MR
QUALITY	+	1.05	PLUS AVE [100%]			
FRAME	99	1.00	N/A [100%]			

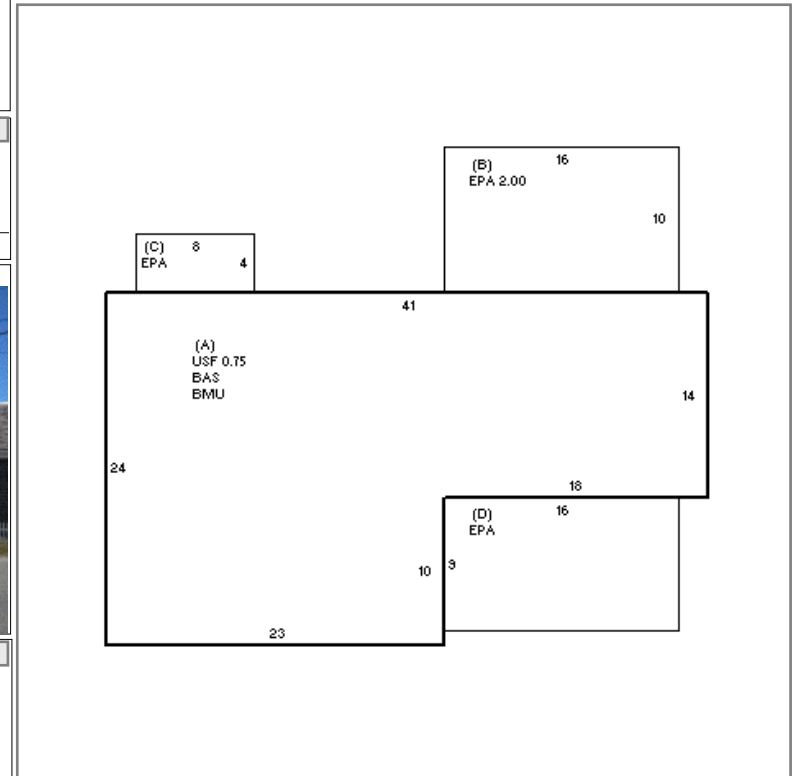

YEAR BLT	1810	SIZE ADJ	1.000
NET AREA	1,407	DETAIL ADJ	4.830
\$NLA(RCN)	\$1,344	OVERALL	1.000
CAPACITY		UNITS	ADJ
ROOMS	8	1.00	
BEDROOMS	3	1.00	
FULL BATHS	2	1.00	
1/2 BATHS	1	1.00	
FIXTURES	8	\$32,461	

ELEMENT	CD	DESCRIPTION	ADJ
COMPLEX	46	CHANNEL VIEW	4.20
UNIT MODEL	99	N/A	1.00
VIEW/LOC	4	GOOD WV	1.15
HVAC	1	FORCED AIR	1.00
FUEL SOURCE	1	OIL	1.00
FLOOR LEVEL	99	N/A	1.00
NEIGHBORHOOD	2	CHATHAM	1.00

S	BAT	T	DESCRIPTION	UNITS	YB	ADJ PRICE	RCN
A	BMU	N	BSMT UNFINISHED	804		23.00	18,492
A	BAS	L	BAS AREA	804	1810	1,317.44	1,059,225
A	USF	L	UP-STRY FIN	603	1810	1,251.69	754,768
+	EPA	N	ENCL PORCH	496		43.80	21,725
	F21	O	FPL 2S 10P	1		4,742.00	4,742

TOTAL RCN	1,891,413
CONDITION ELEM	CD
INTERIOR	G
KITCHEN	G
BATHS	G
EXTERIOR	G
EFF.YR/AGE	1983 / 39
COND	12 12 %
FUNC	0
ECON	0
DEPR	12 % GD 88
RCNLD	\$1,664,400