

Key: 5422

Town of CHATHAM - Fiscal Year 2024

9/7/2023 9:38 am SEQ #: 5.876

LEGALS AND

Table with columns: CURRENT OWNER, PARCEL ID, LOCATION, TRANSFER HISTORY, DOS, T, SALE PRICE, BK-PG (Certs). Includes owner info for Wilson Donald T & Driscoll Ginna Irene and transfer history.

Table with columns: CLASS, CLASS%, DESCRIPTION, BN ID, BN, CARD. Includes payment history for 1010 class with single family description.

Table with columns: CD, T, AC/SF/UN, Nbhd, Infl1, Infl2, ADJ BASE, SAF, Infl3, Lpi, VC, CREDIT AMT, ADJ VALUE. Includes totals for assessed, current, and previous values.

Table with columns: TY, QUAL, COND, DIM/NOTE, YB, UNITS, ADJ PRICE, RCNLD. Includes zoning and lot information.

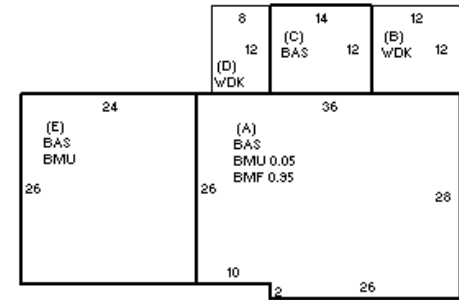

Table with columns: BUILDING, CD, ADJ, DESC, MEASURE, 2/23/2022, TCK. Includes building details like model, style, quality, and frame.

Table with columns: BLDG COMMENTS. Currently empty.

DETAILED

BUILDING

Large summary table with columns: YEAR BLT, NET AREA, \$NLA(RCN), CAPACITY, UNITS, ADJ, ELEMENT, CD, DESCRIPTION, ADJ, S, BAT, T, DESCRIPTION, UNITS, YB, ADJ PRICE, RCN, TOTAL RCN, 704.011, CONDITION ELEM, CD, EFF.YR/AGE, 2012 / 10, COND, FUNC, ECON, DEPR, RCNLD, \$633,600.