

Key: 59

Town of CHATHAM - Fiscal Year 2024

9/7/2023 9:38 am SEQ #: 67

LEGALS AND

Table with columns: CURRENT OWNER, PARCEL ID, LOCATION, TRANSFER HISTORY, DOS, T, SALE PRICE, BK-PG (Cert). Includes owner LUCEY MICHAEL P & CAROLYN M and parcel 10C-14-15.

Table with columns: CLASS, CLASS%, DESCRIPTION, BN ID, BN, CARD. Includes payment history for 1010 SINGLE FAMILY.

Table with columns: TOTAL, ZONING, R20, FRNT, ASSESSED, CURRENT, PREVIOUS. Includes assessed value of 1,942,000.

Table with columns: TY, QUAL, COND, DIM/NOTE, YB, UNITS, ADJ PRICE, RCNLD. Includes building details like model, style, quality.



Table with columns: BLDG COMMENTS. Includes building details like model, style, quality, and frame.

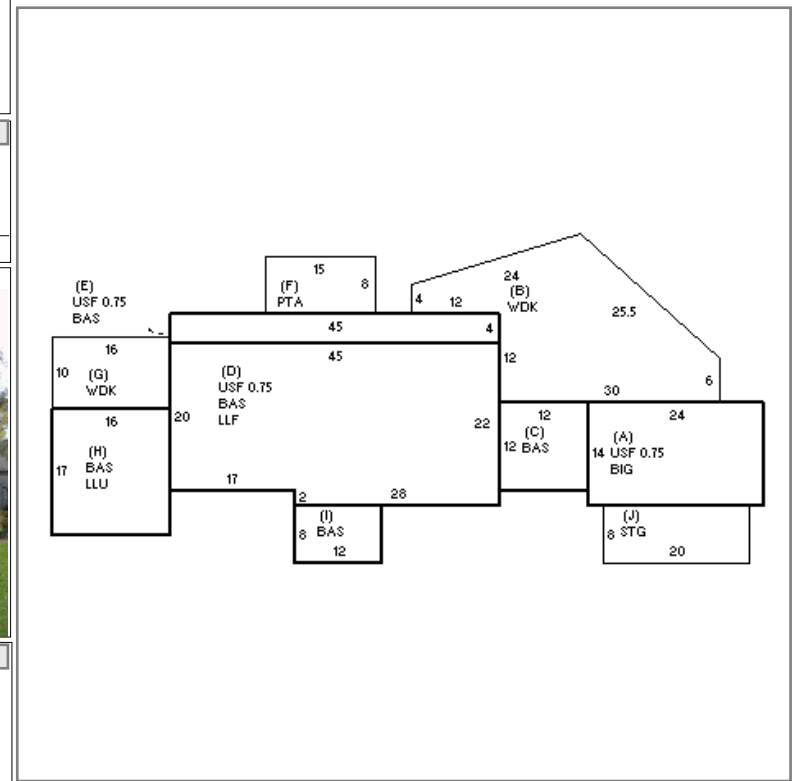

DETACHED

BUILDING

Table with columns: YEAR BLT, SIZE ADJ, NET AREA, \$NLA(RCN), CAPACITY, UNITS, ADJ. Includes building statistics like year built (1980) and net area (2,752).

Table with columns: ELEMENT, CD, DESCRIPTION, ADJ. Includes foundation, roof, floor, and heating details.

Table with columns: S, BAT, T, DESCRIPTION, UNITS, YB, ADJ PRICE, RCN. Includes structural and material details like built-in garage and wood shingle.

Table with columns: TOTAL RCN, CONDITION ELEM, CD, EFF. YR/AGE, COND, FUNC, ECON, DEPR, RCNLD. Includes total RCN of 1,382,075 and depreciation details.