

Key: 5930

Town of CHATHAM - Fiscal Year 2024

9/7/2023 9:38 am SEQ #: 6.394

LEGAL

LAND

DETACHED

BUILDING

CURRENT OWNER				PARCEL ID				LOCATION			
MATULIS JOHN C & ELAINE E 260 BECKLEY RD BERLIN, CT 06037-2506				6D-63-X9				83 SWEETBRIAR DR			
TRANSFER HISTORY				DOS	T	SALE PRICE	BK-PG (Cert)				
MATULIS JOHN C & ELAINE E				09/01/1984	QS	50,000	(C98-9)				

CLASS	CLASS%	DESCRIPTION			BN ID	BN	CARD	
1020	100	CONDOMINIUM				1	1 of 1	
PMT NO	PMT DT	TY	DESC	AMOUNT	INSP	BY	1st	%
22-506	06/10/2022	11	Window Rplc	4,000	04/18/2023	NF	100	100
16-578	09/23/2016	10	Reroof	3,900	05/01/2017	NF	100	100
12-003	01/05/2012	99	n/a		05/02/2014	MR	100	100
1988033	02/23/1988	99	n/a				100	100

CD	T	AC/SF/UN	Nbhd	Inf1	Inf2	ADJ BASE	SAF	Inf3	Lpi	VC	CREDIT AMT	ADJ VALUE

TOTAL	SF	ZONING	R20	FRNT	0	ASSESSED	CURRENT	PREVIOUS
Nbhd		NOTE				LAND	0	0
Inf1			BUILDING	445,200	398,200			
Inf2			DETACHED	0	0			
			OTHER	0	0			
						TOTAL	445,200	398,200

TY	QUAL	COND	DIM/NOTE	YB	UNITS	ADJ PRICE	RCNLD

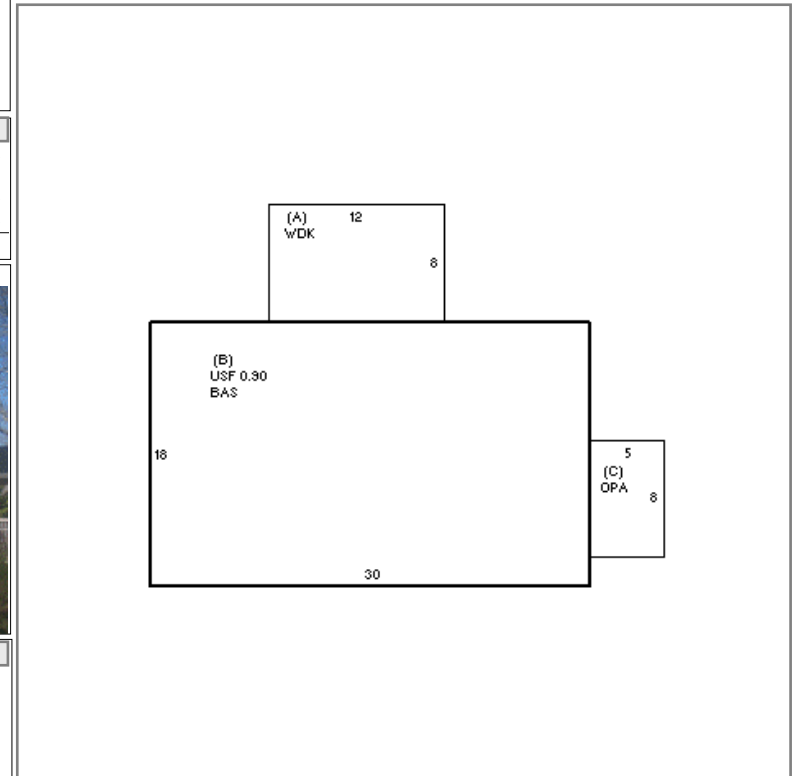

BUILDING	CD	ADJ	DESC	MEASURE	6/30/2016	WFF
MODEL	10		CONDO	LIST	6/30/2016	EST
STYLE	2	1.00	FREE STANDING [100%]	REVIEW	5/8/2023	EMZ
QUALITY	A	1.00	AVERAGE [100%]			
FRAME	99	1.00	N/A [100%]			

BLDG COMMENTS

YEAR BLT	1952	SIZE ADJ	1.000
NET AREA	1,026	DETAIL ADJ	1.854
\$NLA(RCN)	\$542	OVERALL	1.000
CAPACITY		UNITS	ADJ
ROOMS	0	1.00	
BEDROOMS	3	1.00	
FULL BATHS	2	1.00	
1/2 BATHS	0	1.00	
FIXTURES	6	\$8,899	

ELEMENT	CD	DESCRIPTION	ADJ
COMPLEX	59	CHATHAM CREST	1.80
UNIT MODEL	99	N/A	1.00
VIEW/LOC	1	NONE	1.00
HVAC	9	WARM/COOL AIR	1.03
FUEL SOURCE	2	GAS	1.00
FLOOR LEVEL	99	N/A	1.00
NEIGHBORHOOD	4	SOUTH	1.00

S	BAT	T	DESCRIPTION	UNITS	YB	ADJ PRICE	RCN
A	WDK	N	ATT WOOD DECK	96		19.00	1,824
B	BAS	L	BAS AREA	540	1952	542.76	293,090
B	USF	L	UP-STRY FIN	486	1952	515.67	250,615
C	OPA	N	OPEN PORCH	40		24.90	996
	ODS	O	OUT DOOR SHWR-A	1		1,022.00	1,022

TOTAL RCN	556,446	
CONDITION ELEM		CD
INTERIOR		A
KITCHEN		A
BATHS		A
EXTERIOR		A
EFF.YR/AGE	1960 / 62	
COND	20 20 %	
FUNC	0	
ECON	0	
DEPR	20 % GD 80	
RCNLD	\$445,200	