

Key: 655

Town of CHATHAM - Fiscal Year 2024

9/7/2023 9:38 am SEQ #: 743

LEGAL

CURRENT OWNER				PARCEL ID		LOCATION			
CHARLES L BLAUER FAMILY TRUST BLAUER CHARLES L & CLAIRE C TRSTES 2111 GREAT MEADOW RD DEDHAM, MA 02026				11E-30Y-X26		1241 MAIN ST			
TRANSFER HISTORY				DOS	T	SALE PRICE	BK-PG (Cert)		
CHARLES L BLAUER FAMILY T				12/01/1984	QS	191,200	4351-60		

CLASS	CLASS%	DESCRIPTION			BN ID	BN	CARD	
1020	100	CONDOMINIUM				1	1 of 1	
PMT NO	PMT DT	TY	DESC	AMOUNT	INSP	BY	1st	%
12-311	06/19/2012	2	Additions	230,000	07/05/2017	NF	100	100

LAND

CD	T	AC/SF/UN	Nbhd	Inf1	Inf2	ADJ BASE	SAF	Inf3	Lpi	VC	CREDIT AMT	ADJ VALUE

TOTAL	SF	ZONING	R20	FRNT	0	ASSESSED	CURRENT	PREVIOUS
Nbhd		NOTE DISTANT PONDVIEW				LAND	0	0
Inf1			BUILDING	1,051,700	941,400			
Inf2			DETACHED	0	0			
			OTHER	0	0			
						<b>TOTAL</b>	<b>1,051,700</b>	<b>941,400</b>

DETACHED

TY	QUAL	COND	DIM/NOTE	YB	UNITS	ADJ PRICE	RCNLD	PHOTO
								06/13/2019



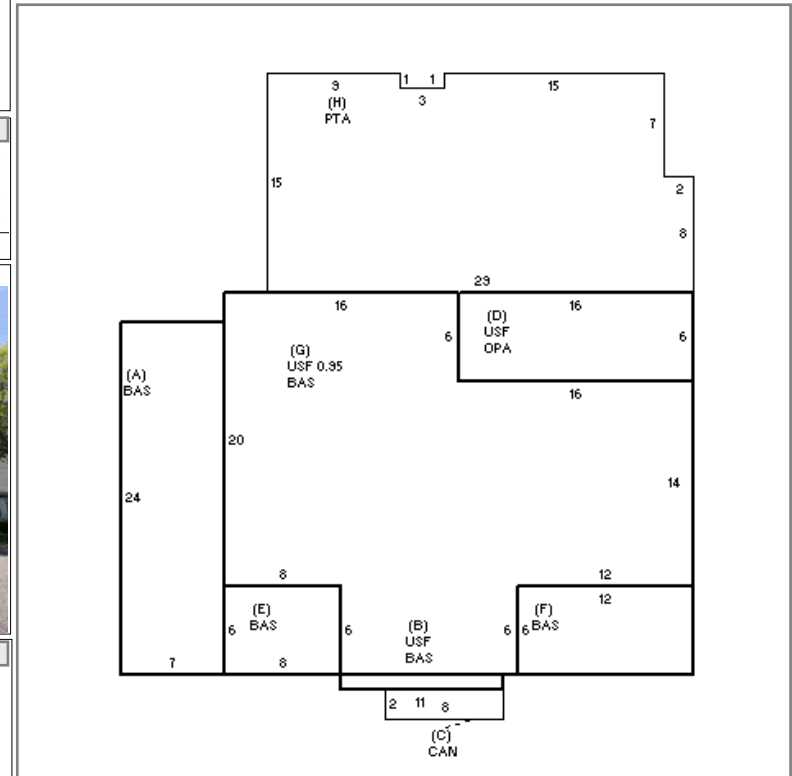

BU

BUILDING	CD	ADJ	DESC	MEASURE	9/25/2019	APK	BLDG COMMENTS
MODEL	10		CONDO	LIST			UNIT 26 - BLDG 4
STYLE	4	1.00	TOWN HSE MID [100%]	REVIEW	9/25/2019	APK	
QUALITY	+	1.05	PLUS AVE [100%]				
FRAME	99	1.00	N/A [100%]				

I L D I N G

YEAR BLT	1984	SIZE ADJ	1.000	ELEMENT	CD	DESCRIPTION	ADJ	S	BAT	T	DESCRIPTION	UNITS	YB	ADJ PRICE	RCN	TOTAL RCN	1,051,719
NET AREA	1,607	DETAIL ADJ	2.487	COMPLEX	6	OYSTER POND	2.10	+	BAS	L	BAS AREA	915	1984	649.23	594,048		
\$NLA(RCN)	\$654	OVERALL	1.000	UNIT MODEL	99	N/A	1.00	+	USF	L	UP-STRY FIN	692	1984	616.83	426,845		
				VIEW/LOC	4	GOOD WV	1.15	C	CAN	N	CANOPY	16		14.38	230		
				HVAC	9	WARM/COOL AIR	1.03	D	OPA	N	OPEN PORCH	96		24.90	2,390		
ROOMS	6		1.00	FUEL SOURCE	2	GAS	1.00	H	PTA	N	PATIO	418		5.70	2,383		
BEDROOMS	3		1.00	FLOOR LEVEL	99	N/A	1.00		GFP	O	GAS LOG/FP/E FP	1		2,846.00	2,846		
FULL BATHS	3		1.00	NEIGHBORHOOD	5	WEST	1.00										
1/2 BATHS	1		1.00														
FIXTURES	11		\$22,977														

CONDITION ELEM	CD
INTERIOR	V
KITCHEN	V
BATHS	V
EXTERIOR	V

EFF.YR/AGE	2020 / 2
COND	0 0 %
FUNC	0
ECON	0
DEPR	0 % GD 100
RCNLD	\$1,051,700