

Key: 6619

Town of CHATHAM - Fiscal Year 2024

9/7/2023 9:38 am SEQ #: 7.090

LEGALS AND

Table with columns: CURRENT OWNER, PARCEL ID, LOCATION, TRANSFER HISTORY, DOS, T, SALE PRICE, BK-PG (Cert). Includes owner JENNESS MARK J & ANN D and transfer history from 04/19/2012 to 09/08/1956.

Table with columns: CLASS, CLASS%, DESCRIPTION, BN ID, BN, CARD. Includes entries for 21-763, 20-120, 20-121, and 20-036.

Table with columns: CD, T, AC/SF/UN, Nbhd, Inf1, Inf2, ADJ BASE, SAF, Inf3, Lpi, VC, CREDIT AMT, ADJ VALUE. Includes totals for assessed, current, and previous values.

Table with columns: ZONING, FRNT, ASSESSED, CURRENT, PREVIOUS. Includes zoning R20 and assessed values for land, building, and other.

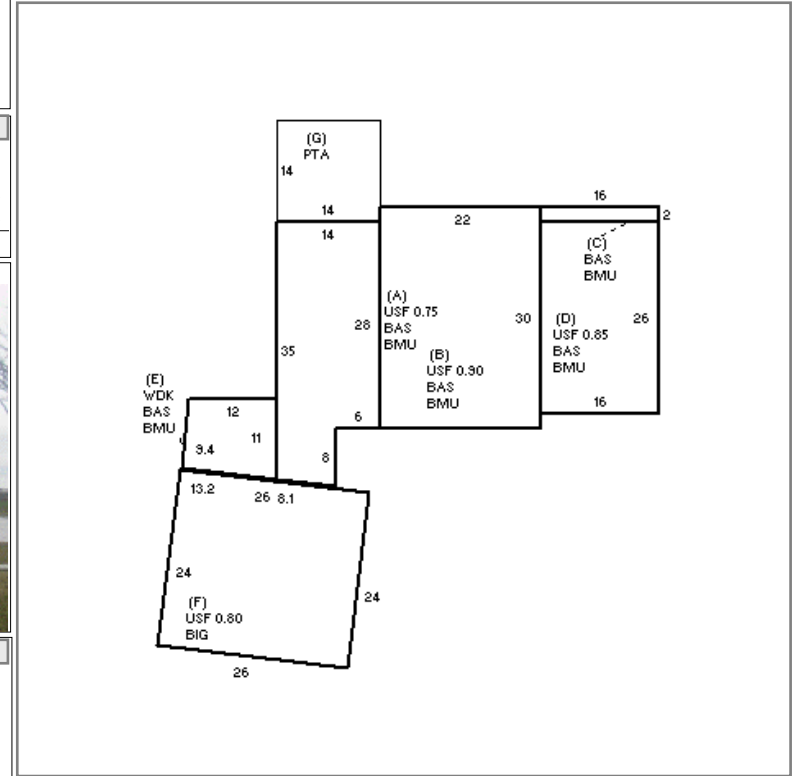

Table with columns: BUILDING, CD, ADJ, DESC, MEASURE, 4/22/2021, NF. Includes building model, style, quality, and frame details.

BLDG COMMENTS: INTERIOR ESTIMATED PER PLANS 7/1/2021

DETACHED

BUILDING

Large summary table with columns: YEAR BLT, NET AREA, \$NLA(RCN), CAPACITY, UNITS, ADJ, ELEMENT, CD, DESCRIPTION, ADJ, S, BAT, T, DESCRIPTION, UNITS, YB, ADJ PRICE, RCN, TOTAL RCN, CONDITION ELEM, CD. Includes detailed breakdown of building elements and costs.