

Key: 6678

Town of CHATHAM - Fiscal Year 2024

9/7/2023 9:38 am SEQ #: 7.153

LEGALS AND

Table with columns: CURRENT OWNER, PARCEL ID, LOCATION, TRANSFER HISTORY, DOS, T, SALE PRICE, BK-PG (Cert). Includes owner DAVENPORT SHERRY L & COLARUSSO RICHARD A and parcel 8B-42A-12.

Table with columns: CLASS, CLASS%, DESCRIPTION, BN ID, BN, CARD. Includes payment history for 1010 and 100 classes.

Table with columns: CD, T, AC/SF/UN, Nbhhd, Inf1, Inf2, ADJ BASE, SAF, Inf3, Lpi, VC, CREDIT AMT, ADJ VALUE. Includes totals for assessed, current, and previous values.

Table with columns: TY, QUAL, COND, DIM/NOTE, YB, UNITS, ADJ PRICE, RCNLD. Includes property details like 42X10 lot and 8 SIDES @ 3'.

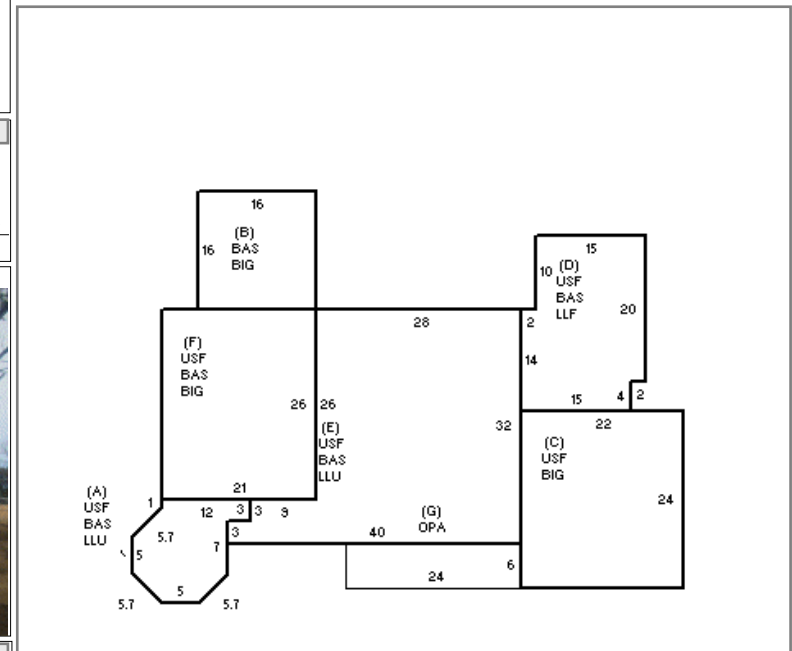

DETAILED

Table with columns: BUILDING, CD, ADJ, DESC, MEASURE, 1/24/2020, NF, LIST, 4/12/2023, EST, REVIEW, 4/21/2023, EMZ. Includes building quality and frame details.

BLDG COMMENTS: LLF= EXERCISE RM, BATH (PER OWNER 4/12/2023) INT EST FROM PLANS 2/6/20

BUILDING

Large table with columns: YEAR BLT, NET AREA, \$NLA(RCN), CAPACITY, UNITS, ADJ, ELEMENT, CD, DESCRIPTION, ADJ, S, BAT, T, DESCRIPTION, UNITS, YB, ADJ PRICE, RCN, TOTAL RCN, CONDITION ELEM, CD. Includes detailed building specifications and RCN breakdown.