

Key: 6726

Town of CHATHAM - Fiscal Year 2024

9/7/2023 9:38 am SEQ #: 7.203

LEG  
AL  
LAND

| CURRENT OWNER  |   |          |      | PARCEL ID                 |      |             |     | LOCATION         |     |            |              |           |
|--|---|----------|------|---------------------------|------|-------------|-----|------------------|-----|------------|--------------|-----------|
| HELFENSTEIN MARY HOPE & ROBERT N<br>12140 TOSCANA WAY #103<br>BONITA SPRINGS, FL 34135 |   |          |      | 8C-11-S72                 |      |             |     | 76 MARSH VIEW RD |     |            |              |           |
|  |   |          |      | TRANSFER HISTORY          |      |             |     | DOS              | T   | SALE PRICE | BK-PG (Cert) |           |
|  |   |          |      | HELFENSTEIN MARY HOPE & R |      |             |     | 06/20/2016       | A   | 1 (209883) |              |           |
| HELFENSTEIN MARY HOPE  |   |          |      | 09/25/2013                | A    | 1 (201533)  |     |                  |     |            |              |           |
| CHITTICK COLETTE M   |   |          |      | 07/21/2007                | H    | 1 (1071921) |     |                  |     |            |              |           |
| CD   | T | AC/SF/UN | Nbhd | Inf1                      | Inf2 | ADJ BASE    | SAF | Inf3             | Lpi | VC         | CREDIT AMT   | ADJ VALUE |
| 100  | S | 26,000   | WC   | 1.00                      | 100  | 1.00        | 100 | 1.00             | VW2 | 1.85       |              | 576,820   |

| CLASS   | CLASS%     | DESCRIPTION   |             |        | BN ID      | BN  | CARD   |     |
|---------|------------|---------------|-------------|--------|------------|-----|--------|-----|
| 1010    | 100        | SINGLE FAMILY |             |        |            | 1   | 1 of 1 |     |
| PMT NO  | PMT DT     | TY            | DESC        | AMOUNT | INSP       | BY  | 1st    | %   |
| 21-806  | 11/03/2021 | 20            | Splits/Land |        | 11/03/2021 | APK | 100    | 100 |
|         | 09/13/2021 | 12            | INSULATION  | 6,700  | 11/03/2021 | APK | 100    | 100 |
|         | 02/10/2009 | 50            | Meas & List |        |            | RRC | 100    | 100 |
| 1983178 | 09/27/1983 | 99            | n/a         |        |            |     | 100    | 100 |

DETACHED

| TOTAL        | 26,000 SF    | ZONING | R20      | FRNT    | 80      | ASSESSED | CURRENT        | PREVIOUS       |
|--------------|--------------|--------|----------|---------|---------|----------|----------------|----------------|
| Nbhd         | WEST CHATHAM | NOTE   |          |         |         | LAND     | 576,800        | 480,700        |
| Inf1         | 100          |        | BUILDING | 240,800 | 219,200 |          |                |                |
| Inf2         | 100          |        | DETACHED | 0       | 0       |          |                |                |
|              |              |        | OTHER    | 0       | 0       |          |                |                |
| <b>TOTAL</b> |              |        |          |         |         |          | <b>817,600</b> | <b>699,900</b> |

| TY | QUAL | COND | DIM/NOTE | YB | UNITS | ADJ PRICE | RCNLD |
|----|------|------|----------|----|-------|-----------|-------|
|    |      |      |          |    |       |           |       |

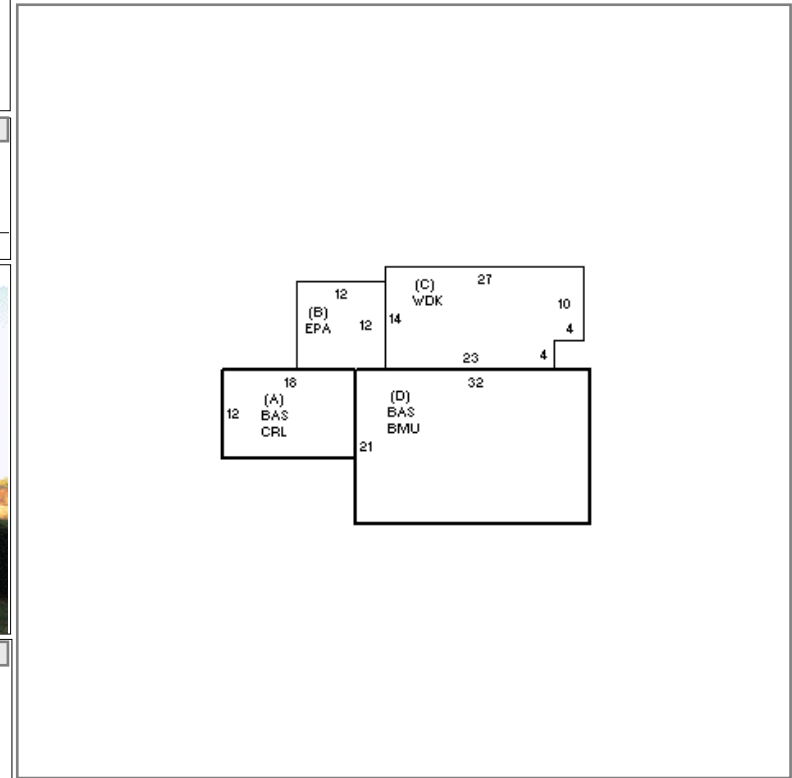

BUILDING

| BUILDING | CD | ADJ  | DESC              | MEASURE | 11/3/2021 | APK |
|----------|----|------|-------------------|---------|-----------|-----|
| MODEL    | 1  |      | RESIDENTIAL       | LIST    | 11/3/2021 | APK |
| STYLE    | 1  | 0.85 | RANCH [100%]      | REVIEW  | 11/3/2021 | APK |
| QUALITY  | A  | 1.00 | AVERAGE [100%]    |         |           |     |
| FRAME    | 1  | 1.00 | WOOD FRAME [100%] |         |           |     |

BLDG COMMENTS

UNIT

| YEAR BLT   | 1961  | SIZE ADJ   | 1.000 |
|------------|-------|------------|-------|
| NET AREA   | 888   | DETAIL ADJ | 0.892 |
| \$NLA(RCN) | \$387 | OVERALL    | 1.000 |
| CAPACITY   |       | UNITS      | ADJ   |
| STORIES    | 1     | 1.00       |       |
| ROOMS      | 6     | 1.00       |       |
| BEDROOMS   | 3     | 1.00       |       |
| FULL BATHS | 1     | 1.00       |       |
| 1/2 BATHS  | 1     | 1.00       |       |
| FIXTURES   | 5     | \$3,568    |       |
| UNITS      | 1     | 1.00       |       |

| ELEMENT      | CD | DESCRIPTION    | ADJ  |
|--------------|----|----------------|------|
| FOUNDATION   | 4  | FLR & WALL     | 1.00 |
| EXT. COVER   | 1  | WOOD SHINGLE   | 1.00 |
| ROOF SHAPE   | 1  | GABLE          | 1.00 |
| ROOF COVER   | 1  | ASPH/CMP SHIN  | 1.00 |
| FLOOR COVER  | 1  | HARDWOOD       | 1.00 |
| INT. FINISH  | 2  | DRYWALL        | 1.00 |
| HEATING/COOL | 11 | HT-WT/COOL AIR | 1.05 |
| FUEL SOURCE  | 1  | OIL            | 1.00 |

| S | BAT | T | DESCRIPTION     | UNITS | YB   | ADJ PRICE | RCN     |
|---|-----|---|-----------------|-------|------|-----------|---------|
| A | CRL | N | CRAWL SPACE     | 216   |      | 22.15     | 4,784   |
| + | BAS | L | BAS AREA        | 888   | 1961 | 266.13    | 236,324 |
| B | EPA | N | ENCL PORCH      | 144   |      | 133.70    | 19,253  |
| C | WDK | N | WOOD DECK       | 362   |      | 58.40     | 21,141  |
| D | BMU | N | BSMT UNFINISHED | 672   |      | 74.47     | 50,045  |
|   | F11 | O | FPL 1S 1OP      | 1     |      | 7,477.00  | 7,477   |
|   | ODS | O | OUT DOOR SHWR-A | 1     |      | 1,477.00  | 1,477   |

| TOTAL RCN         | 344,069    |
|-------------------|------------|
| CONDITION ELEM CD |            |
| EXTERIOR          | A          |
| INTERIOR          | G          |
| KITCHEN           | A          |
| BATHS             | A          |
| HEAT              | A          |
| ELECT             | U          |
| EFF.YR/AGE        | 1973 / 49  |
| COND              | 30 30 %    |
| FUNC              | 0          |
| ECON              | 0          |
| DEPR              | 30 % GD 70 |
| RCNLD             | \$240,800  |