

Key: 682

Town of CHATHAM - Fiscal Year 2024

9/7/2023 9:38 am SEQ #: 769

LEGAL

LAND

DETACHED

BUILDING

| CURRENT OWNER | | PARCEL ID | | LOCATION | |
|---|--|------------|----|------------------|--------------|
| ROGERS PUNAM S & MITCHEL J 66 THE CORNFIELD CHATHAM, MA 02633 | | 11E-43-D4 | | 66 THE CORNFIELD | |
| TRANSFER HISTORY | | DOS | T | SALE PRICE | BK-PG (Cert) |
| ROGERS PUNAM S & MITCHEL | | 07/28/2017 | QS | 735,000 | 30659-336 |
| GILBERT ANDREW & DANA | | 07/22/2015 | QS | 650,000 | 29028-317 |
| RUDNICK SETH A & CAROLYN | | 05/28/2009 | QS | 495,000 | 23745-103 |

| CLASS | CLASS% | DESCRIPTION | | BN ID | BN | CARD | |
|--------|------------|---------------|--------------|--------|------------|--------|---------|
| 1010 | 100 | SINGLE FAMILY | | | 1 | 1 of 1 | |
| PMT NO | PMT DT | TY | DESC | AMOUNT | INSP | BY | 1st % |
| 23-568 | 07/11/2023 | 77 | SOLAR PANELS | 30,000 | | | 100 100 |
| 19-102 | 02/21/2019 | 11 | Window Rplc | 18,000 | 02/25/2019 | TCK | 100 100 |
| 18-981 | 11/26/2018 | 3 | Renovations | 2,912 | 02/25/2019 | TCK | 100 100 |
| | 05/07/2007 | 50 | Meas & List | | | RRC | 100 100 |
| | 02/17/2003 | 50 | Meas & List | | | JB | 100 100 |

| CD | T | AC/SF/UN | Nbhd | Inf1 | Inf2 | ADJ BASE | SAF | Inf3 | Lpi | VC | CREDIT AMT | ADJ VALUE |
|-----|---|----------|------|------|------|----------|------|------|-----|------|------------|-----------|
| 100 | S | 14,105 | WC | 1.00 | 1.00 | 641,375 | 2.39 | 1.00 | R06 | 1.75 | | 495,740 |

| TOTAL | 14,105 SF | ZONING | R20 | FRNT | 100 | ASSESSED | | CURRENT | 495,700 | PREVIOUS | 413,100 |
|-------|--------------|--|-----------|---------|---------|----------|--|---------|---------|----------|---------|
| Nbhd | WEST CHATHAM | NOTE 1/12TH INTEREST IN 40FT WIDE PRIVATE WAY | LAND | 576,000 | 530,000 | | | | | | |
| Inf1 | 100 | | BUILDING | 0 | 0 | | | | | | |
| Inf2 | 100 | | DETACHED | 0 | 0 | | | | | | |
| | | | OTHER | 0 | 0 | | | | | | |
| | | TOTAL | 1,071,700 | 943,100 | | | | | | | |

| TY | QUAL | COND | DIM/NOTE | YB | UNITS | ADJ PRICE | RCNLD |
|----|------|------|----------|----|-------|-----------|-------|
| | | | | | | | |



| BUILDING | CD | ADJ | DESC | MEASURE |
|----------|----|------|-------------------|--------------------|
| MODEL | 1 | | RESIDENTIAL | |
| STYLE | 5 | 1.00 | COLONIAL [100%] | |
| QUALITY | + | 1.20 | PLUS AVE [100%] | |
| FRAME | 1 | 1.00 | WOOD FRAME [100%] | |
| | | | | REVIEW 6/4/2019 TD |

| YEAR BLT | 1980 | SIZE ADJ | 1.000 | ELEMENT | CD | DESCRIPTION | ADJ | S | BAT | T | DESCRIPTION | UNITS | YB | ADJ PRICE | RCN |
|------------|-------|------------|-------|--------------|----|---------------|------|-----|-----|-----------------|-----------------|-------|-----------|-----------|---------|
| NET AREA | 1,669 | DETAIL ADJ | 1.030 | FOUNDATION | 4 | FLR & WALL | 1.00 | + | BMU | N | BSMT UNFINISHED | 1,000 | | 86.86 | 86,861 |
| \$NLA(RCN) | \$383 | OVERALL | 1.000 | EXT. COVER | 1 | WOOD SHINGLE | 1.00 | + | BAS | L | BAS AREA | 1,000 | 1980 | 312.97 | 312,966 |
| CAPACITY | | UNITS | ADJ | ROOF SHAPE | 6 | SALTBOX | 1.00 | + | USF | L | UP-STRY FIN | 669 | 1980 | 265.56 | 177,661 |
| STORIES | 1.75 | 1.00 | | ROOF COVER | 1 | ASPH/CMP SHIN | 1.00 | C | OSP | N | OPEN SCR PORCH | 80 | | 94.56 | 7,565 |
| ROOMS | 0 | 1.00 | | FLOOR COVER | 2 | SOFTWOOD | 1.00 | D | AGR | N | ATTACHED GARAGE | 308 | | 100.43 | 30,934 |
| BEDROOMS | 4 | 1.00 | | INT. FINISH | 2 | DRYWALL | 1.00 | E | PTA | N | PATIO/STOOP | 180 | | 21.48 | 3,866 |
| FULL BATHS | 2 | 1.00 | | HEATING/COOL | 9 | WARM/COOL AIR | 1.03 | F21 | O | FPL 2S 1OP | 1 | | 12,451.20 | 12,451 | |
| 1/2 BATHS | 0 | 1.00 | | FUEL SOURCE | 2 | GAS | 1.00 | ODS | O | OUT DOOR SHWR-A | 1 | | 1,772.40 | 1,772 | |
| FIXTURES | 6 | \$5,933 | | | | | | | | | | | | | |
| UNITS | 1 | 1.00 | | | | | | | | | | | | | |

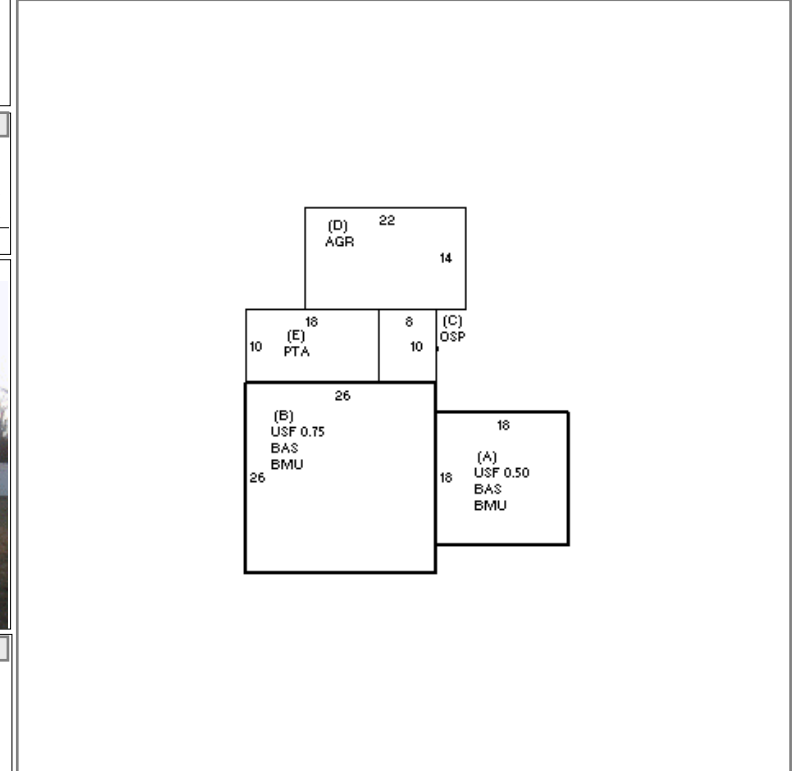

| BLDG COMMENTS | |
|---------------|--|
|---------------|--|

| TOTAL RCN | 640,009 |
|----------------|---------|
| CONDITION ELEM | CD |
| EXTERIOR | G |
| INTERIOR | G |
| KITCHEN | V |
| BATHS | G |
| HEAT | U |
| ELECT | U |

| EFF.YR/AGE | 2012 / 10 |
|------------|------------|
| COND | 10 10% |
| FUNC | 0 |
| ECON | 0 |
| DEPR | 10 % GD 90 |
| RCNLD | \$576,000 |