

Key: 7415

Town of CHATHAM - Fiscal Year 2024

9/7/2023 9:38 am SEQ #: 7.907

LEGAL

CURRENT OWNER		PARCEL ID	LOCATION		
TURPIN JOHN LOUIS & JULIE K 10 VIOLET PL RHINEBECK, NY 12572		9D-31F-X6	54 YOUNGS RD		
TRANSFER HISTORY		DOS	T	SALE PRICE	BK-PG (Cert)
TURPIN JOHN LOUIS & JULIE DOGGART		01/23/1998 12/01/1979	99 QS	191,500 36,900	11184-18 3033-244

CLASS	CLASS%	DESCRIPTION		BN ID	BN	CARD	
1020	100	CONDOMINIUM			1	1 of 1	
PMT NO	PMT DT	TY	DESC	AMOUNT	INSP	BY	1st %
22-119	02/03/2022	10	Reroof	9,700	04/19/2023	NF	100 100
99-324	04/01/1999	99	n/a	2,500			100 100
1989163	09/15/1989	99	n/a				100 100

LAND

CD	T	AC/SF/UN	Nbhd	Inf1	Inf2	ADJ BASE	SAF	Inf3	Lpi	VC	CREDIT AMT	ADJ VALUE

TOTAL	SF	ZONING	R20	FRNT	0	ASSESSED	CURRENT	PREVIOUS
Nbhd		NOTE				LAND	0	0
Inf1			BUILDING	797,600	658,200			
Inf2			DETACHED	0	0			
			OTHER	0	0			
						TOTAL	797,600	658,200

DETACHED

TY	QUAL	COND	DIM/NOTE	YB	UNITS	ADJ PRICE	RCNLD	PHOTO
								04/19/2023
								

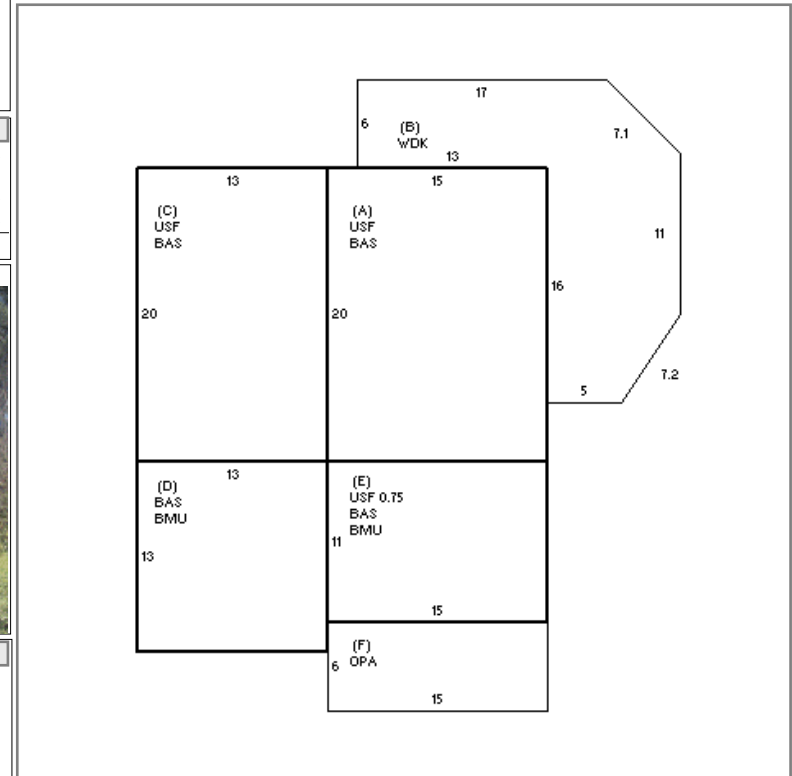

BUILDING

BUILDING	CD	ADJ	DESC	MEASURE	7/1/2016	WFF
MODEL	10		CONDO	LIST	7/1/2016	EST
STYLE	2	1.00	FREE STANDING [100%]	REVIEW	5/8/2023	EMZ
QUALITY	A	1.00	AVERAGE [100%]			
FRAME	99	1.00	N/A [100%]			

BLDG COMMENTS		

YEAR BLT	1952	SIZE ADJ	1.000	ELEMENT	CD	DESCRIPTION	ADJ	S	BAT	T	DESCRIPTION	UNITS	YB	ADJ PRICE	RCN	TOTAL RCN	896.165
NET AREA	1,578	DETAIL ADJ	2.250	COMPLEX	64	PINEHILL COTTAG	2.25	+	BAS	L	BAS AREA	894	1952	562.67	503,027		
\$NLA(RCN)	\$568	OVERALL	1.000	UNIT MODEL	99	N/A	1.00	+	USF	L	UP-STRY FIN	684	1952	534.59	365,657		
				VIEW/LOC	1	NONE	1.00	B	WDK	N	ATT WOOD DECK	252		19.00	4,788		
				HVAC	1	FORCED AIR	1.00	+	BMU	N	BSMT UNFINISHED	334		23.00	7,682		
				FUEL SOURCE	1	OIL	1.00	F	OPA	N	OPEN PORCH	90		24.90	2,241		
				FLOOR LEVEL	99	N/A	1.00	MST	O	MASONRY STACK	1			948.00	948		
				NEIGHBORHOOD	5	WEST	1.00	ODS	O	OUT DOOR SHWR-A	1			1,022.00	1,022		
																CONDITION ELEM	CD
																INTERIOR	
																KITCHEN	
																BATHS	
																EXTERIOR	
																EFF.YR/AGE	1988 / 34
																COND	11 11 %
																FUNC	0
																ECON	0
																DEPR	11 % GD 89
																RCNLD	\$797,600