

Key: 8076

Town of CHATHAM - Fiscal Year 2024

9/7/2023 9:38 am SEQ #: 8.558

LEGAL LAND

Table with columns: CURRENT OWNER, PARCEL ID, LOCATION, TRANSFER HISTORY, DOS, T, SALE PRICE, BK-PG (Cert). Includes owner info for MAGNER THOMAS G & NANCY G and transfer history details.

Table with columns: CLASS, CLASS%, DESCRIPTION, BN ID, BN, CARD. Includes details for PMT NO, PMT DT, TY, DESC, AMOUNT, INSP, BY, 1st, %.

DETAILED

Summary table with columns: TOTAL, ZONING, FRNT, ADJ PRICE, ASSESSED, CURRENT, PREVIOUS. Includes zoning R20 and assessed values.

Table with columns: TY, QUAL, COND, DIM/NOTE, YB, UNITS, ADJ PRICE, RCNLD. Includes a photo of the property dated 03/25/2022.

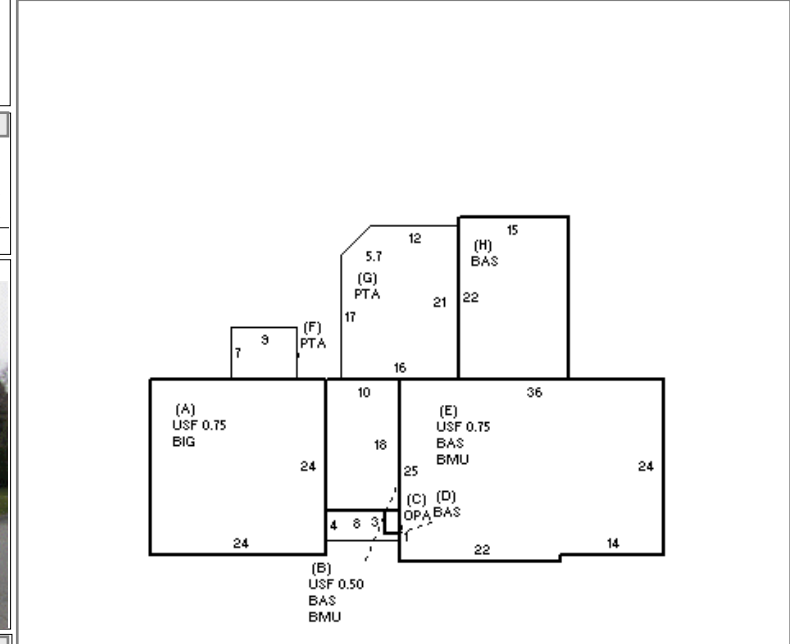

BUILDING

Table with columns: BUILDING, CD, ADJ, DESC, MEASURE, 10/15/2019, TCK. Includes details for residential building quality and frame.

BLDG COMMENTS section for the property.

INDING

Main summary table with columns: YEAR BLT, SIZE ADJ, ELEMENT, CD, DESCRIPTION, ADJ, S, BAT, T, DESCRIPTION, UNITS, YB, ADJ PRICE, RCN, TOTAL RCN, 880,291. Includes detailed breakdown of building elements and costs.

Summary table with columns: EFF.YR/AGE, 2020 / 2, COND, FUNC, ECON, DEPR, RCNLD, \$862,700. Includes depreciation and condition metrics.