

Key: 8079

Town of CHATHAM - Fiscal Year 2024

9/7/2023 9:38 am SEQ #: 8.561

LEGAL LAND

Table with columns: CURRENT OWNER, PARCEL ID, LOCATION, TRANSFER HISTORY, DOS, T, SALE PRICE, BK-PG (Cert). Includes owner info for THE DIMKE FAMILY TRUST and transfer history from 2019 to 2023.

Table with columns: CLASS, CLASS%, DESCRIPTION, BN ID, BN, CARD. Includes details for SINGLE FAMILY class with various additions, measurements, and renovations.

Table with columns: TOTAL, 20,038 SF, ZONING, R20, FRNT, 134, ASSESSED, CURRENT, PREVIOUS. Includes assessed values for land, building, detached, and other.

Table with columns: TY, QUAL, COND, DIM/NOTE, YB, UNITS, ADJ PRICE, RCNLD. Includes property details like IPG, PTD, and dimensions.

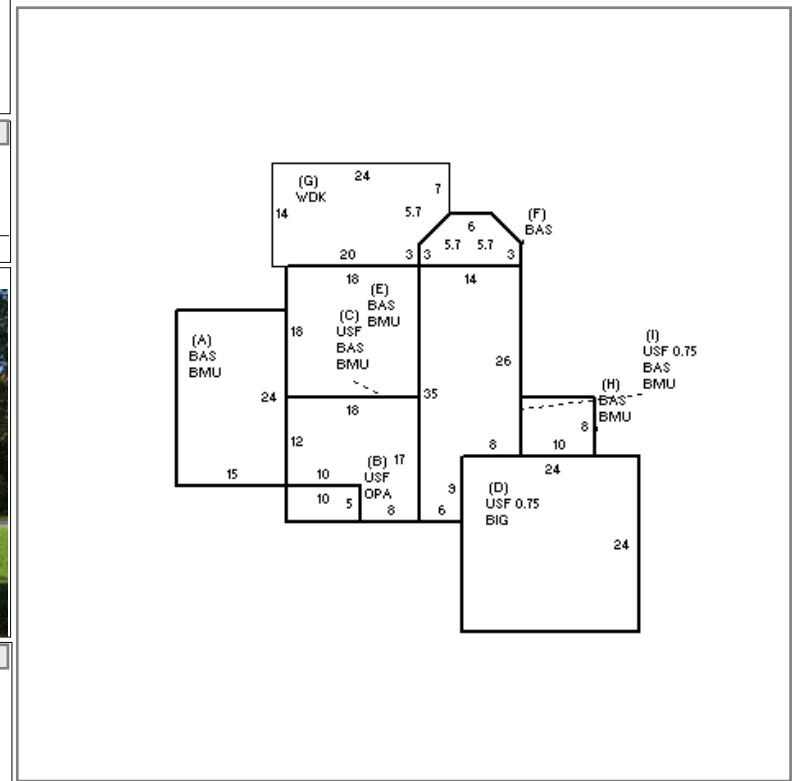

Table with columns: BUILDING, CD, ADJ, DESC, MEASURE, 10/15/2019, TCK. Includes building details like model, style, quality, and frame.

Table with columns: BLDG COMMENTS. Includes the note: HATCH & PULL DOWN STAIRS TO ATTIC.

DETACHED

BUILDING

Large summary table with columns: YEAR BLT, NET AREA, \$NLA(RCN), CAPACITY, UNITS, ADJ, ELEMENT, CD, DESCRIPTION, ADJ, S, BAT, T, DESCRIPTION, UNITS, YB, ADJ PRICE, RCN, TOTAL RCN, 1,193,688, CONDITION ELEM, CD, EFF. YR/AGE, 2007 / 15, COND, FUNC, ECON, DEPR, RCNLD, \$1,014,600.