

CONSTRUCTION DETAIL			CONSTRUCTION DETAIL (CONTINUED)		
Element	Cd	Description	Element	Cd	Description
Style:	93	Inn/B+B			
Model	01	Residential			
Grade:	10	Superior			
Stories:	2.5	2 1/2 Stories			
Occupancy	9				
Exterior Wall 1	14	Wood Shingle			
Exterior Wall 2					
Roof Structure:	03	Gable/Hip			
Roof Cover	03	Asph/F Gls/Cmp			
Interior Wall 1	03	Plastered			
Interior Wall 2	05	Drywall/Sheet			
Interior Flr 1	12	Hardwood			
Interior Flr 2	09	Pine/Soft Wood			
Heat Fuel	02	Oil			
Heat Type:	05	Hot Water			
AC Type:	02	Heat Pump			
Total Bedrooms	08	8 Bedrooms			
Total Bthrms:	8				
Total Half Baths	2				
Total Xtra Fixtrs					
Total Rooms:	0				
Bath Style:					
Kitchen Style:					
CONDO DATA					
Parcel Id		C	Owne		0.0
Adjust Type		Code	Description		Factor%
Condo Flr			Condo Unit		
COST / MARKET VALUATION					
Building Value New				2,614,428	
Year Built				1892	
Effective Year Built				2016	
Depreciation Code				R	
Remodel Rating				04	
Year Remodeled				2017	
Depreciation %				5	
Functional Obsol				5	
External Obsol				0	
Trend Factor				1	
Condition					
Condition %				90	
Pcnt Good				90	
Cns Sect Rcnld				2,353,000	
Dep % Ovr					
Dep Ovr Comment					
Misc Imp Ovr					
Misc Imp Ovr Comment					
Cost to Cure Ovr					
Cost to Cure Ovr Comment					

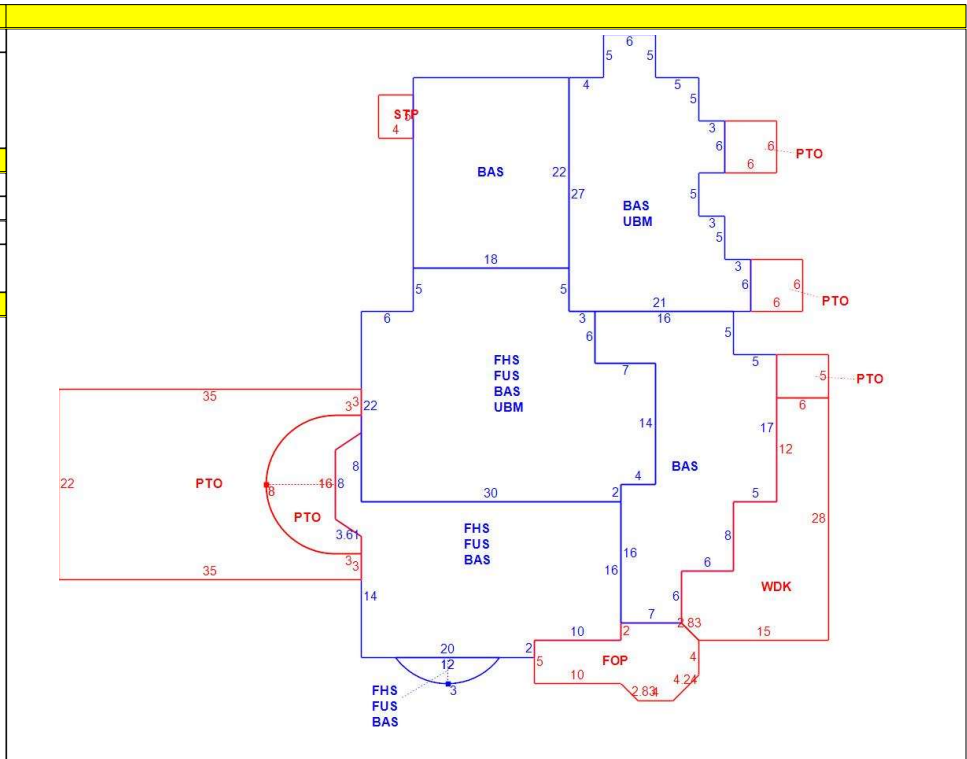

OB - OUTBUILDING & YARD ITEMS(L) / XF - BUILDING EXTRA FEATURES(B)										
Code	Description	L/B	Units	Unit Price	Yr Blt	Cond. Cd	% Gd	Grade	Grade Adj.	Appr. Value
CLR1	COOLER	B	48	37.00	2001		90		0.00	1,600
SPR2	WET/CONCE	B	3,000	2.10			90		0.00	5,700

BUILDING SUB-AREA SUMMARY SECTION						
Code	Description	Living Area	Floor Area	Eff Area	Unit Cost	Undeprec Value
BAS	First Floor	2,742	2,742	2,742	488.80	1,340,290
FHS	Half Story, Finished	682	1,363	682	244.58	333,362
FOP	Porch, Open, Finished	0	123	25	99.35	12,220
FUS	Upper Story, Finished	1,363	1,363	1,363	488.80	666,234
PTO	Patio	0	842	84	48.76	41,059
STP	Stoop	0	20	2	48.88	978
UBM	Basement, Unfinished	0	1,292	258	97.61	126,110
WDK	Deck, Wood	0	294	29	48.21	14,175
Ttl Gross Liv / Lease Area		4,787	8,039	5,185		2,534,428

