

| CURRENT OWNER  |            | TOPO  | UTILITIES         | STRT / ROAD               | LOCATION             | CURRENT ASSESSMENT |   |                                |                                | 1302<br>EDGARTOWN, MA<br><b>VISION</b> |           |                  |                     |                       |            |           |           |
|--|------------|---|-------------------|---------------------------|----------------------|--------------------|---|--------------------------------|--------------------------------|--|-----------|------------------|---------------------|-----------------------|------------|-----------|-----------|
| EDGARTOWN YACHT CLUB   |            |   | 3 Public Sewer    | 9 Town Street             |                      | Description        | Code  | Appraised                      | Assessed                       |  |           |                  |                     |                       |            |           |           |
| BOX 1309   |            |   |                   | 1 Paved                   |                      | RESIDENTL          | 0130  | 349,790                        | 349,790                        |  |           |                  |                     |                       |            |           |           |
| EDGARTOWN MA 02539   |            | <b>SUPPLEMENTAL DATA</b>  |                   |                           | RES LND              | 0130               | 675,032   | 675,032                        |                                |  |           |                  |                     |                       |            |           |           |
| Alt Prcl ID<br>PLN#/Rec CF 495 SEAFOOD SHANT<br>Lot# 1<br>Plan Notes<br>Plan Notes<br>Plan Notes<br>GIS ID M_282689_793702 |            | Restriction<br>Hist Distrct X<br>Other Note<br>UC-Misc 1<br>UC-Misc 2<br>Assoc Pid# |                   |                           | COMMERCL<br>COMM LND | 0310<br>0310       | 1,087,710<br>2,335,668  | 1,087,710<br>2,335,668         |                                |  |           |                  |                     |                       |            |           |           |
|  |            |   |                   |                           |                      | Total              |   | 4,448,200                      | 4,448,200                      |  |           |                  |                     |                       |            |           |           |
| RECORD OF OWNERSHIP  |            | BK-VOL/PAGE   | SALE DATE         | Q/U                       | V/I                  | SALE PRICE         | VC  | PREVIOUS ASSESSMENTS (HISTORY) |                                |  |           |                  |                     |                       |            |           |           |
| EDGARTOWN YACHT CLUB   |            | 0597  | 0659              | 01-15-1993                | Q                    | I                  | 962,500   | 00                             | Year                           | Code                                   | Assessed  | Year             | Code                | Assessed              |            |           |           |
| TOMASSIAN JANE C--TRS  |            | 00491   | 0562              | 12-31-1987                | Q                    | I                  | 375,000   | 00                             | 2023                           | 0130                                   | 349,790   | 2022             | 0130                | 286,254               |            |           |           |
|  |            |   |                   |                           |                      |                    |   |                                |                                | 0130                                   | 675,032   |                  | 0130                | 433,068               |            |           |           |
|  |            |   |                   |                           |                      |                    |   |                                |                                | 0310                                   | 1,087,710 |                  | 0310                | 955,946               |            |           |           |
|  |            |   |                   |                           |                      |                    |   |                                |                                | 0310                                   | 2,335,668 |                  | 0310                | 1,498,424             |            |           |           |
|  |            |   |                   |                           |                      | Total              |   | 4,448,200                      | Total                          |  | 3,173,692 | Total            |                     | 2,732,092             |            |           |           |
| EXEMPTIONS   |            |   | OTHER ASSESSMENTS |                           |                      |                    | This signature acknowledges a visit by a Data Collector or Assessor |                                |                                |  |           |                  |                     |                       |            |           |           |
| Year   | Code       | Description   | Amount            | Code                      | Description          | Number             | Amount  | Comm Int                       |                                |  |           |                  |                     |                       |            |           |           |
|  |            |   |                   |                           |                      |                    |   |                                | <b>APPRAISED VALUE SUMMARY</b> |  |           |                  |                     |                       |            |           |           |
|  |            | Total   | 0.00              |                           |                      |                    |   |                                |                                | Appraised Bldg. Value (Card)           |           |                  | 1,376,700           |                       |            |           |           |
|  |            |   |                   |                           |                      |                    |   | Appraised Xf (B) Value (Bldg)  |                                |  | 2,600     |                  |                     |                       |            |           |           |
|  |            |   |                   |                           |                      |                    |   | Appraised Ob (B) Value (Bldg)  |                                |  | 58,200    |                  |                     |                       |            |           |           |
|  |            |   |                   |                           |                      |                    |   | Appraised Land Value (Bldg)    |                                |  | 3,010,700 |                  |                     |                       |            |           |           |
|  |            |   |                   |                           |                      |                    |   | Special Land Value             |                                |  | 0         |                  |                     |                       |            |           |           |
|  |            |   |                   |                           |                      |                    |   | Total Appraised Parcel Value   |                                |  | 4,448,200 |                  |                     |                       |            |           |           |
|  |            |   |                   |                           |                      |                    |   | Valuation Method               |                                |  | C         |                  |                     |                       |            |           |           |
|  |            |   |                   |                           |                      |                    |   | Total Appraised Parcel Value   |                                |  | 4,448,200 |                  |                     |                       |            |           |           |
| ASSESSING NEIGHBORHOOD   |            | Nbhd  | Nbhd Name         | B                         | Tracing              | Batch              |   |                                |                                |  |           |                  |                     |                       |            |           |           |
|  |            | CBD1  |                   |                           |                      |                    |   |                                |                                |  |           |                  |                     |                       |            |           |           |
| NOTES  |            |   |                   |                           |                      |                    |   |                                |                                |  |           |                  |                     |                       |            |           |           |
| WALKWAY EASEMENT ALONG WATER   |            |   |                   | F = UP                    |                      |                    |   |                                |                                |  |           |                  |                     |                       |            |           |           |
| ADJ TO TOWN PARKING LOT  |            |   |                   |                           |                      |                    |   |                                |                                |  |           |                  |                     |                       |            |           |           |
| PIER FNDTN   |            |   |                   |                           |                      |                    |   |                                |                                |  |           |                  |                     |                       |            |           |           |
|  |            |   |                   | *TOTAL LOT SZ = 8,974 SF* |                      |                    |   |                                |                                |  |           |                  |                     |                       |            |           |           |
| JUNIOR YACHT CLUB BLD -FAR LEFT IN PHOTO   |            |   |                   |                           |                      |                    |   |                                |                                |  |           |                  |                     |                       |            |           |           |
| BUILDING PERMIT RECORD   |            |   |                   |                           |                      |                    |   | VISIT / CHANGE HISTORY         |                                |  |           |                  |                     |                       |            |           |           |
| Permit Id  | Issue Date | Type  | Description       | Amount                    | Insp Date            | % Comp             | Date Comp   | Comments                       | Date                           | Id                                     | Type      | Is               | Cd                  | Purpost/Result        |            |           |           |
| 2021-747   | 04-13-2021 | RA  | Res Add/Alter     | 10,000                    |                      | 100                |   | EXT REPAIRS BLDG & STAIR       | 07-14-2022                     | EH                                     |           |                  | 01                  | Cyclical Reinspection |            |           |           |
|  |            |   |                   |                           |                      |                    |   |                                | 05-09-2017                     | DT                                     |           |                  | 11                  | Field Review          |            |           |           |
|  |            |   |                   |                           |                      |                    |   |                                | 12-13-2011                     | EP                                     |           |                  | 01                  | Cyclical Reinspection |            |           |           |
|  |            |   |                   |                           |                      |                    |   |                                | 03-21-2011                     | DT                                     |           |                  | 11                  | Field Review          |            |           |           |
|  |            |   |                   |                           |                      |                    |   |                                | 02-05-2009                     | EP                                     |           |                  | 11                  | Field Review          |            |           |           |
|  |            |   |                   |                           |                      |                    |   |                                | 04-24-2007                     | DT                                     |           |                  | 11                  | Field Review          |            |           |           |
|  |            |   |                   |                           |                      |                    |   |                                | 01-02-2002                     | DT                                     |           |                  | 11                  | Field Review          |            |           |           |
| LAND LINE VALUATION SECTION  |            |   |                   |                           |                      |                    |   |                                |                                |  |           |                  |                     |                       |            |           |           |
| B  | Use Code   | Description   | Zone              | Land Type                 | Land Units           | Unit Price         | I. Factor   | Site Index                     | Cond.                          | Nbhd.                                  | Nbhd Adj  | Notes            | Location Adjustment | Adj Unit Pric         | Land Value |           |           |
| 1  | 0310       | PRI COMM  | B1                |                           | 5,295 SF             | 235.43             | 1.00000   | 0                              | 0.95                           | CBD1                                   | 1.000     | WF/X.95 EASEMT   |                     | 0                     | 335.49     | 1,776,400 |           |
| Total Card Land Units  |            |   |                   |                           | 0.12                 | AC                 | Parcel Total Land Area: 0.21  |                                |                                |  |           | Total Land Value |                     |                       |            |           | 3,010,700 |

| CONSTRUCTION DETAIL |      |                | CONSTRUCTION DETAIL (CONTINUED) |             |             |
|---------------------|------|----------------|---------------------------------|-------------|-------------|
| Element             | Cd   | Description    | Element                         | Cd          | Description |
| Style:              | 80   | Apt/Store      |                                 |             |             |
| Model               | 94   | Commercial     |                                 |             |             |
| Grade               | 03   | Average        |                                 |             |             |
| Stories:            | 1.75 |                |                                 |             |             |
| Occupancy           | 2.00 |                |                                 |             |             |
| Exterior Wall 1     | 14   | Wood Shingle   |                                 |             |             |
| Exterior Wall 2     |      |                |                                 |             |             |
| Roof Structure      | 03   | Gable/Hip      |                                 |             |             |
| Roof Cover          | 03   | Asph/F GlS/Cmp |                                 |             |             |
| Interior Wall 1     | 05   | Drywall/Sheet  |                                 |             |             |
| Interior Wall 2     |      |                |                                 |             |             |
| Interior Floor 1    | 09   | Pine/Soft Wood |                                 |             |             |
| Interior Floor 2    | 14   | Carpet         |                                 |             |             |
| Heating Fuel        | 04   | Electric       |                                 |             |             |
| Heating Type        | 07   | Electr Basebrd |                                 |             |             |
| AC Type             | 02   | Heat Pump      |                                 |             |             |
| Bldg Use            | 0310 | PRI COMM       |                                 |             |             |
| Total Rooms         |      |                |                                 |             |             |
| Total Bedrms        | 00   |                |                                 |             |             |
| Total Baths         | 1    |                |                                 |             |             |
| Heat/AC             | 00   | NONE           |                                 |             |             |
| Frame Type          | 02   | WOOD FRAME     |                                 |             |             |
| Baths/Plumbing      | 02   | AVERAGE        |                                 |             |             |
| Ceiling/Wall        | 06   | CEIL & WALLS   |                                 |             |             |
| Rooms/Prtns         | 02   | AVERAGE        |                                 |             |             |
| Wall Height         | 8.00 |                |                                 |             |             |
| % Comn Wall         | 0.00 |                |                                 |             |             |
| 1st Floor Use:      | 3220 |                |                                 |             |             |
|                     |      |                | <b>MIXED USE</b>                |             |             |
|                     |      |                | Code                            | Description | Percentage  |
|                     |      |                | 0310                            | PRI COMM    | 62          |
|                     |      |                | 0130                            | PRI RES     | 38          |
|                     |      |                |                                 |             | 0           |
|                     |      |                | <b>COST / MARKET VALUATION</b>  |             |             |
|                     |      |                | RCN                             |             | 1,179,718   |
|                     |      |                | Year Built                      |             | 1981        |
|                     |      |                | Effective Year Built            |             | 1999        |
|                     |      |                | Depreciation Code               |             | G           |
|                     |      |                | Remodel Rating                  |             |             |
|                     |      |                | Year Remodeled                  |             |             |
|                     |      |                | Depreciation %                  |             | 22          |
|                     |      |                | Functional Obsol                |             | 5           |
|                     |      |                | External Obsol                  |             |             |
|                     |      |                | Trend Factor                    |             | 1           |
|                     |      |                | Condition                       |             |             |
|                     |      |                | Condition %                     |             |             |
|                     |      |                | Percent Good                    |             | 73          |
|                     |      |                | Cns Sect Rcndd                  |             | 861,200     |
|                     |      |                | Dep % Ovr                       |             |             |
|                     |      |                | Dep Ovr Comment                 |             |             |
|                     |      |                | Misc Imp Ovr                    |             |             |
|                     |      |                | Misc Imp Ovr Comment            |             |             |
|                     |      |                | Cost to Cure Ovr                |             |             |
|                     |      |                | Cost to Cure Ovr Comment        |             |             |

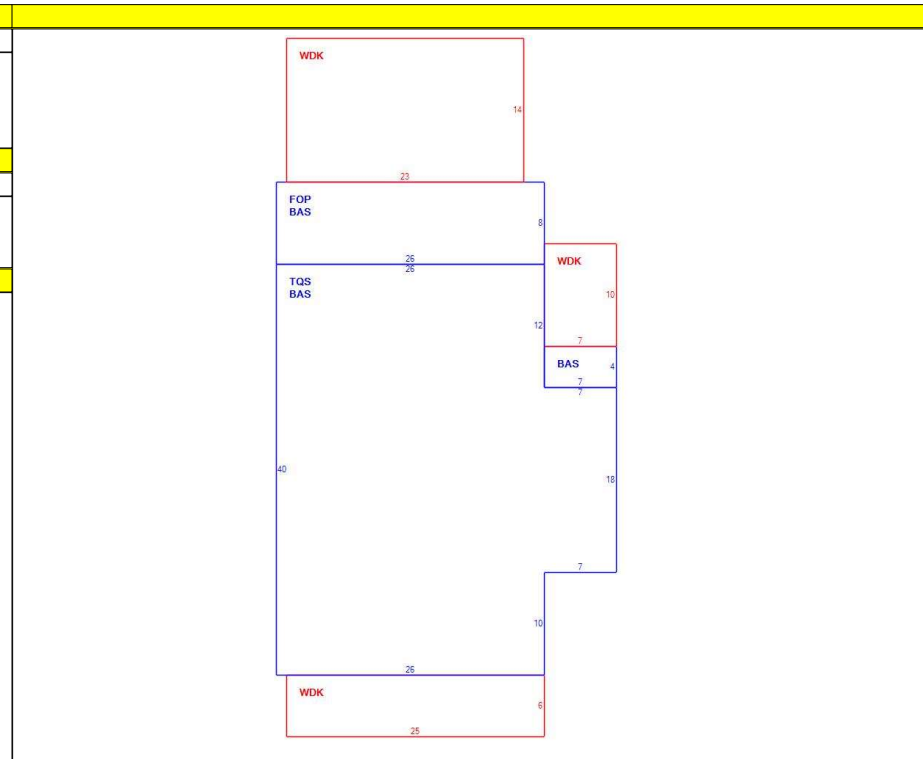

| OB - OUTBUILDING & YARD ITEMS(L) / XF - BUILDING EXTRA FEATURES(B) |             |     |       |            |        |          |        |       |           |             |
|--|-------------|-----|-------|------------|--------|----------|--------|-------|-----------|-------------|
| Code   | Description | L/B | Units | Unit Price | Yr Blt | Cond. Cd | % Good | Grade | Grade Adj | Appr. Value |
| DCK2   | COM TYPE    | L   | 300   | 126.00     | 1990   |          | 50     |       | 0.00      | 18,900      |
| DCK2   | COM TYPE    | L   | 600   | 126.00     | 1990   |          | 50     |       | 0.00      | 37,800      |
| SPR1   | SPRINKLERS- | B   | 2,415 | 1.50       | 1996   |          | 73     |       | 0.00      | 2,600       |

| BUILDING SUB-AREA SUMMARY SECTION |                       |             |            |          |           |                |  |
|-----------------------------------|-----------------------|-------------|------------|----------|-----------|----------------|--|
| Code                              | Description           | Living Area | Floor Area | Eff Area | Unit Cost | Undeprec Value |  |
| BAS                               | First Floor           | 1,402       | 1,402      | 1,402    | 467.03    | 654,776        |  |
| FOP                               | Porch, Open, Finished | 0           | 208        | 52       | 116.76    | 24,286         |  |
| TQS                               | Three Quarter Story   | 991         | 1,166      | 991      | 396.94    | 462,827        |  |
| WDK                               | Deck, Wood            | 0           | 542        | 81       | 69.80     | 37,829         |  |
| Ttl Gross Liv / Lease Area        |                       | 2,393       | 3,318      | 2,526    |           | 1,179,718      |  |



| CURRENT OWNER        |  | TOPO                     | UTILITIES            | STRT / ROAD   | LOCATION       | CURRENT ASSESSMENT |      |           |           |  |
|----------------------|--|--------------------------|----------------------|---------------|----------------|--------------------|------|-----------|-----------|--|
| EDGARTOWN YACHT CLUB |  |                          | 3 Public Sewer       | 9 Town Street |                | Description        | Code | Appraised | Assessed  | 1302<br><br>EDGARTOWN, MA<br><br><b>VISION</b> |
| BOX 1309             |  |                          |                      | 1 Paved       |                | RESIDENTL          | 0130 | 349,790   | 349,790   |  |
|                      |  | <b>SUPPLEMENTAL DATA</b> |                      |               |                | RES LND            | 0130 | 675,032   | 675,032   |  |
| EDGARTOWN MA 02539   |  | Alt Prcl ID              | CF 495 SEAFOOD SHANT |               | Restriction    | COMMERCL           | 0310 | 1,087,710 | 1,087,710 |  |
|                      |  | PLN#/Rec                 | 1                    |               | Hist Distrct X | COMM LND           | 0310 | 2,335,668 | 2,335,668 |  |
|                      |  | Lot#                     |                      |               | Other Note     |                    |      |           |           |  |
|                      |  | Plan Notes               |                      |               | UC-Misc 1      |                    |      |           |           |  |
|                      |  | Plan Notes               |                      |               | UC-Misc 2      |                    |      |           |           |  |
|                      |  | Plan Notes               |                      |               |                |                    |      |           |           |  |
|                      |  | GIS ID                   | M_282689_793702      |               | Assoc Pid#     |                    |      |           |           |  |
|                      |  |                          |                      |               |                | Total              |      | 4,448,200 | 4,448,200 |  |

| RECORD OF OWNERSHIP   |  | BK-VOL/PAGE | SALE DATE  | Q/U | VI | SALE PRICE | VC | PREVIOUS ASSESSMENTS (HISTORY) |       |           |           |       |           |
|-----------------------|--|-------------|------------|-----|----|------------|----|--------------------------------|-------|-----------|-----------|-------|-----------|
| EDGARTOWN YACHT CLUB  |  | 0597 0659   | 01-15-1993 | Q   | I  | 962,500    | 00 | Year                           | Code  | Assessed  | Year      | Code  | Assessed  |
| TOMASSIAN JANE C--TRS |  | 00491 0562  | 12-31-1987 | Q   | I  | 375,000    | 00 | 2023                           | 0130  | 349,790   | 2022      | 0130  | 286,254   |
|                       |  |             |            |     |    |            |    |                                | 0130  | 675,032   |           | 0130  | 433,068   |
|                       |  |             |            |     |    |            |    |                                | 0310  | 1,087,710 |           | 0310  | 955,946   |
|                       |  |             |            |     |    |            |    |                                | 0310  | 2,335,668 |           | 0310  | 1,498,424 |
|                       |  |             |            |     |    | Total      |    | 4,448,200                      | Total |           | 3,173,692 | Total | 2,732,092 |

| EXEMPTIONS |      |             | OTHER ASSESSMENTS |      |             |        |        |          |
|------------|------|-------------|-------------------|------|-------------|--------|--------|----------|
| Year       | Code | Description | Amount            | Code | Description | Number | Amount | Comm Int |
|            |      |             |                   |      |             |        |        |          |
| Total      |      |             | 0.00              |      |             |        |        |          |

| ASSESSING NEIGHBORHOOD |           |   |         |       |
|------------------------|-----------|---|---------|-------|
| Nbhd                   | Nbhd Name | B | Tracing | Batch |
| CBD1                   |           |   |         |       |

| NOTES                                     |  |
|---|--|
| CAPT. PORKYS=BAS [FRONT] F = UP/LO/SO/AGE |  |
| ICE CREAM + CANDY BAZAAR=BAS (REAR)       |  |
| GENTLES REALTY FLR 2                      |  |
| 2 SKYLIGHTS REAR EAF                      |  |

| APPRAISED VALUE SUMMARY       |           |
|-------------------------------|-----------|
| Appraised Bldg. Value (Card)  | 1,376,700 |
| Appraised Xf (B) Value (Bldg) | 2,600     |
| Appraised Ob (B) Value (Bldg) | 58,200    |
| Appraised Land Value (Bldg)   | 3,010,700 |
| Special Land Value            | 0         |
| Total Appraised Parcel Value  | 4,448,200 |
| Valuation Method              | C         |
| Total Appraised Parcel Value  | 4,448,200 |

| BUILDING PERMIT RECORD |            |      |             |        |           |        | VISIT / CHANGE HISTORY |          |      |    |      |    |    |                |
|------------------------|------------|------|-------------|--------|-----------|--------|------------------------|----------|------|----|------|----|----|----------------|
| Permit Id              | Issue Date | Type | Description | Amount | Insp Date | % Comp | Date Comp              | Comments | Date | Id | Type | Is | Cd | Purpost/Result |
|                        |            |      |             |        |           |        |                        |          |      |    |      |    |    |                |

| LAND LINE VALUATION SECTION |          |             |      |           |            |            |                              |            |       |       |          |                  |                     |               |            |           |
|-----------------------------|----------|-------------|------|-----------|------------|------------|------------------------------|------------|-------|-------|----------|------------------|---------------------|---------------|------------|-----------|
| B                           | Use Code | Description | Zone | Land Type | Land Units | Unit Price | I. Factor                    | Site Index | Cond. | Nbhd. | Nbhd Adj | Notes            | Location Adjustment | Adj Unit Pric | Land Value |           |
| 2                           | 0310     | PRI COMM    | B1   |           | 3,679 SF   | 235.43     | 1.00000                      | 0          | 0.95  | CBD1  | 1.000    |                  |                     | 0             | 335.49     | 1,234,300 |
| Total Card Land Units       |          |             |      |           | 0.08       | AC         | Parcel Total Land Area: 0.21 |            |       |       |          | Total Land Value |                     | 3,010,700     |            |           |

| CONSTRUCTION DETAIL |      |                | CONSTRUCTION DETAIL (CONTINUED) |    |             |
|---------------------|------|----------------|---------------------------------|----|-------------|
| Element             | Cd   | Description    | Element                         | Cd | Description |
| Style:              | 80   | Apt/Store      |                                 |    |             |
| Model               | 94   | Commercial     |                                 |    |             |
| Grade               | 03   | Average        |                                 |    |             |
| Stories:            | 2    |                |                                 |    |             |
| Occupancy           | 3.00 |                |                                 |    |             |
| Exterior Wall 1     | 14   | Wood Shingle   |                                 |    |             |
| Exterior Wall 2     |      |                |                                 |    |             |
| RooF Structure      | 03   | Gable/Hip      |                                 |    |             |
| RooF Cover          | 03   | Asph/F Gls/Cmp |                                 |    |             |
| Interior Wall 1     | 05   | Drywall/Sheet  |                                 |    |             |
| Interior Wall 2     |      |                |                                 |    |             |
| Interior Floor 1    | 09   | Pine/Soft Wood |                                 |    |             |
| Interior Floor 2    | 14   | Carpet         |                                 |    |             |
| Heating Fuel        | 04   | Electric       |                                 |    |             |
| Heating Type        | 07   | Electr Basebrd |                                 |    |             |
| AC Type             | 02   | Heat Pump      |                                 |    |             |
| Bldg Use            | 0310 | PRI COMM       |                                 |    |             |
| Total Rooms         |      |                |                                 |    |             |
| Total Bedrms        | 00   |                |                                 |    |             |
| Total Baths         | 0    |                |                                 |    |             |
| Heat/AC             | 00   | NONE           |                                 |    |             |
| Frame Type          | 02   | WOOD FRAME     |                                 |    |             |
| Baths/Plumbing      | 02   | AVERAGE        |                                 |    |             |
| Ceiling/Wall        | 06   | CEIL & WALLS   |                                 |    |             |
| Rooms/Prtns         | 02   | AVERAGE        |                                 |    |             |
| Wall Height         | 8.00 |                |                                 |    |             |
| % Comn Wall         | 0.00 |                |                                 |    |             |
| 1st Floor Use:      | 3220 |                |                                 |    |             |

| MIXED USE |             |            |
|-----------|-------------|------------|
| Code      | Description | Percentage |
| 0310      | PRI COMM    | 100        |
|           |             | 0          |
|           |             | 0          |

| COST / MARKET VALUATION  |         |
|--------------------------|---------|
| RCN                      | 859,163 |
| Year Built               | 1890    |
| Effective Year Built     | 1991    |
| Depreciation Code        | G       |
| Remodel Rating           |         |
| Year Remodeled           |         |
| Depreciation %           | 30      |
| Functional Obsol         | 10      |
| External Obsol           |         |
| Trend Factor             | 1       |
| Condition                |         |
| Condition %              |         |
| Percent Good             | 60      |
| Cns Sect Rcnd            | 515,500 |
| Dep % Ovr                |         |
| Dep Ovr Comment          |         |
| Misc Imp Ovr             |         |
| Misc Imp Ovr Comment     |         |
| Cost to Cure Ovr         |         |
| Cost to Cure Ovr Comment |         |

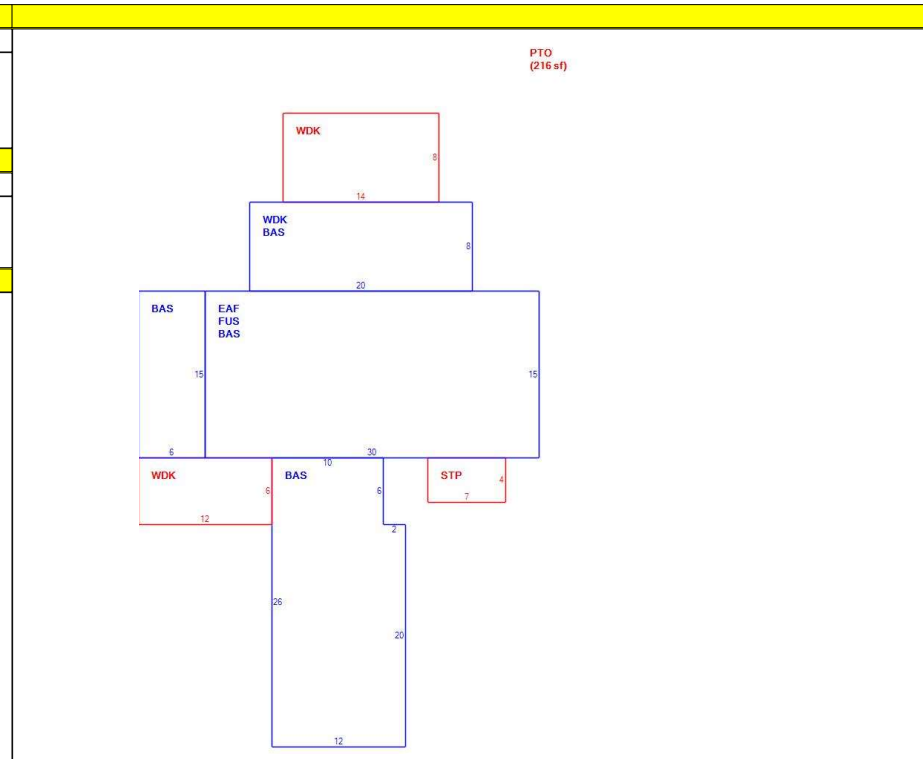

| OB - OUTBUILDING & YARD ITEMS(L) / XF - BUILDING EXTRA FEATURES(B) |               |     |       |            |        |          |        |       |           |             |
|--|---------------|-----|-------|------------|--------|----------|--------|-------|-----------|-------------|
| Code   | Description   | L/B | Units | Unit Price | Yr Blt | Cond. Cd | % Good | Grade | Grade Adj | Appr. Value |
| LT1  | LIGHTS-IN W/P | L   | 3     | 1000.00    | 1982   |          | 50     |       | 0.00      | 1,500       |

| BUILDING SUB-AREA SUMMARY SECTION |                            |             |            |          |           |                |  |
|-----------------------------------|----------------------------|-------------|------------|----------|-----------|----------------|--|
| Code                              | Description                | Living Area | Floor Area | Eff Area | Unit Cost | Undeprec Value |  |
| BAS                               | First Floor                | 1,000       | 1,000      | 1,000    | 494.34    | 494,340        |  |
| EAF                               | Attic, Expansion, Finished | 225         | 450        | 225      | 247.17    | 111,227        |  |
| FUS                               | Upper Story, Finished      | 450         | 450        | 428      | 470.17    | 211,578        |  |
| PTO                               | Patio                      | 0           | 216        | 32       | 73.24     | 15,819         |  |
| STP                               | Stoop                      | 0           | 28         | 1        | 17.65     | 494            |  |
| WDK                               | Deck, Wood                 | 0           | 344        | 52       | 74.73     | 25,706         |  |
| Ttl Gross Liv / Lease Area        |                            | 1,675       | 2,488      | 1,738    |           | 859,164        |  |

